

city mini™ ZIP

by baby jogger®



ASSEMBLY INSTRUCTIONS

TABLE OF CONTENTS

English

Warnings	3
Features	4
Frame	5
Front Wheel	6
Rear Wheels	7
Brake	8
Canopy	9
Adjustable Legrest	10
Safety Harness	11
Seat	13
Basket Removal	15
Folding	16
Care & Maintenance	17
Limited Warranty	18

WARNING

IMPORTANT- Keep these instructions for future reference.

SINGLE STROLLER

- This stroller seats one passenger.
- This vehicle is suitable from birth to 5 years. Maximum weight: 22.6 kg, maximum height: 111.8 cm.
- Total weight load recommended for this stroller is 28 kg (22.6 kg in seat, 1 kg in seat back pocket, 4.5 kg in basket).

WARNING:

- Follow the Manufacturer's instructions.
- Put on all brakes whenever you park the stroller.
- Do not leave children unattended.
- Do not carry extra children or bags on this stroller.
- Secure the child in the harness at all times.
- Make sure children are clear of any moving parts if you adjust the stroller, otherwise they may be injured.
- This product is not suitable for jogging, running, skating, or rollerblading.
- Prevent serious injury to your child by always using the safety harness.
- Parcels or accessory items, or both, placed on the unit may cause the unit to become unstable.
- Stroller is not meant to be used for transporting children up or down stairs or escalators. Damage resulting to stroller will not be covered under warranty.
- Child may slip into leg openings and strangle. Never use in reclined carriage position unless safety harness is properly fastened.
- Any load attached to the handle affects the stability of the stroller.
- Always use the crotch strap in combination with the waist belt.
- Always lock the brake when loading and unloading children.
- Accessories which are not approved by the manufacturer or distributor shall not be used.
- The passenger shall remain seated (no standing in the stroller).
- This stroller is designed for use on flat or gently sloping surfaces. Be aware that the possibility for tipping occurs if this product is used on higher sloping and uneven surfaces.
- Always keep fingers away from moving parts when folding, unfolding, or adjusting the stroller to prevent finger/body part entrapment or pinching.
- Be aware of the risk of open fire and other sources of strong heat, such as electric bar fires, gas fires, heaters, etc., in the near vicinity of the stroller.
- Watch out for cars - never assume that a driver can see you and your child.
- Recommended weight for seat pocket is 1 kg and basket is 4.5 kg. Excessive weight may cause a hazardous unstable condition to exist.
- It may be unsafe to use replacement parts other than those supplied or approved by the manufacturer.

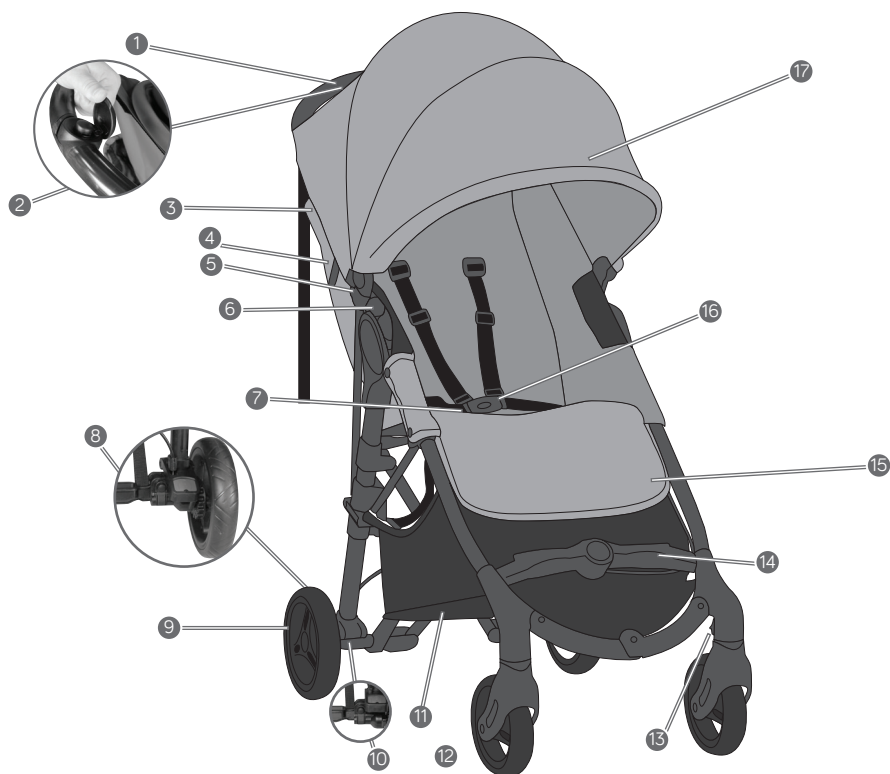

- | | | | |
|---|----------------------------|----|---------------------------|
| 1 | Handlebar | 10 | Rear Wheel Release Button |
| 2 | Handlebar Fold Button | 11 | Storage Basket |
| 3 | Weather Cover | 12 | Front Wheels |
| 4 | AutoLock | 13 | Swivel Lock |
| 5 | Canopy Attachment Bracket | 14 | Footbar/Footrest |
| 6 | Accessory Mounting Bracket | 15 | Adjustable Footwell |
| 7 | Fold Handle | 16 | Harness Buckle |
| 8 | Parking Brake | 17 | Canopy |
| 9 | Rear Wheel | | |

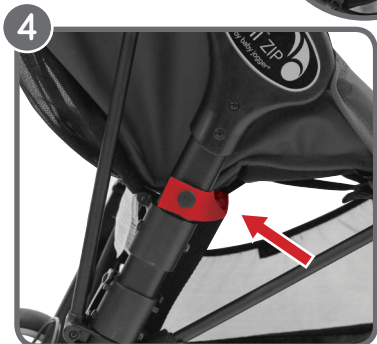
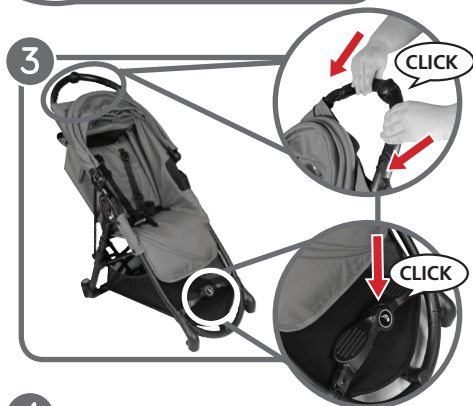
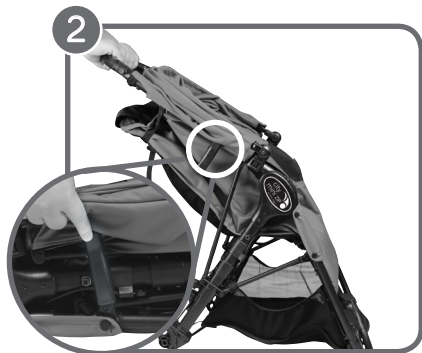

FRAME

- 1 Unpack the stroller from the box and set the wheels aside.
- 2 Unfold the stroller by pressing the Auto-lock release button and lifting the handlebar away from the lower frame.
- 3 Place the stroller in the upright position. Lock handlebar by pressing both sides forward until it clicks. Press foot bar down to lock into place.
- 4 Snap the red Safety Strap to the frame under the fold mechanism before use.

⚠ WARNING: Ensure that all the locking devices are engaged before use.

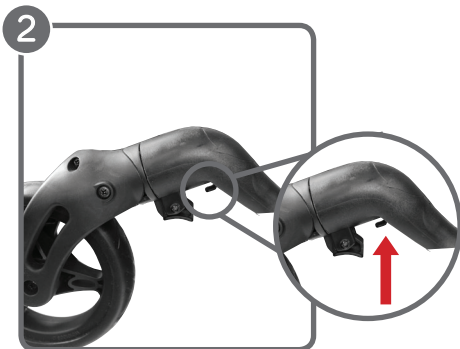

FRONT WHEEL

1 Installation

- Lay stroller on its back so the Handlebar is resting on the floor.
- Attach the front wheels by sliding them into the front wheel mounts until they click. Gently pull on the front wheels to make sure they are properly attached.

2 Removal

- Press wheel release button on back of wheel casing and pull wheel to remove.

SWIVEL LOCK

3 Press the swivel locks down to lock the front wheels in a fixed position for long distance strolling.

4 Press the swivel locks up to allow the front wheels to swivel.

NOTE: When loading and unloading child, lock the front wheels in a fixed position. Although the front wheels of your City Mini ZIP lock, it is not intended for jogging or exercise purposes.

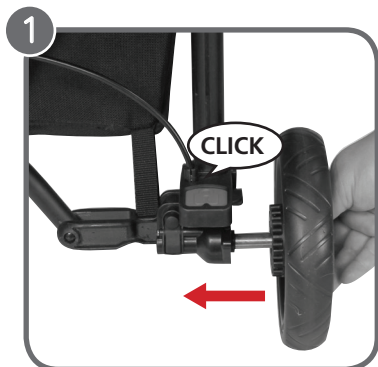

REAR WHEELS

1 Installation

- Align the Rear Wheel axle with the wheel mount on the stroller frame and insert it into the wheel mount until it clicks into place.
- Gently pull on the Rear Wheel to make sure it is properly attached.

2 Removal

- Press the wheel release button next to the brake and pull wheel to release.





BRAKE

- 1 Simply push the red parking brake down to engage the brakes.
- 2 Press the green brake release down to release the brakes.

⚠ WARNING: Always apply the brakes whenever the stroller is stationary.

WRIST STRAP

- 3 Always use the wrist strap when stroller is in use.

⚠ WARNING: Use this strap to stop the stroller rolling away.



CANOPY

- 1 Insert canopy attachments into canopy attachment brackets on each side of the stroller. Click into place.
- 2 Attach velcro along back of canopy to seat.
- 3 Snap the canopy straps to the back of the handlebar. Connect the velcro on the ends of the straps.
- 4 To remove: Unfasten all snaps and velcro on the canopy. Press canopy attachments to remove from attachment brackets.





ADJUSTABLE LEGREST

- 1 Press the adjustment levers located underneath the legrest and move legrest up or down until desired position is reached.

CUP HOLDER

- 2 Attach the cup holder to the attachment knob on the right side of the handlebar. Click into place.

NOTE: Containers carrying hot liquids should not be used. Do not add more than 1 lb (0.5 kg) to cup holder.



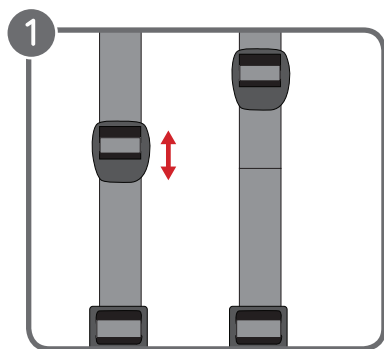

SAFETY HARNESS

- 1 To adjust harness height: Slide upper section of shoulder straps up and down to fit close to your child's shoulders.
- 2 To adjust harness length: Hold the plastic guide and pull the strap end to tighten, or pull the upper harness strap to loosen.

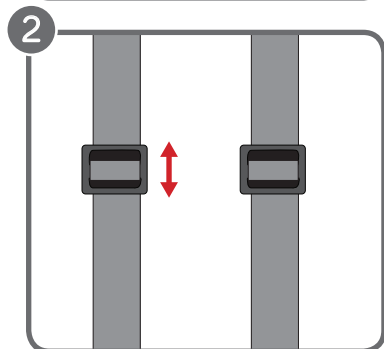

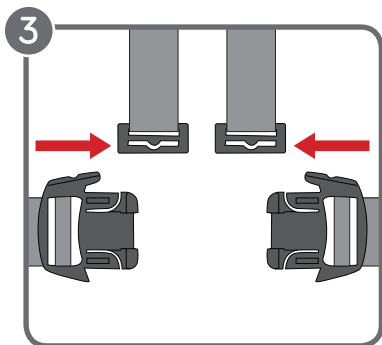

- 3 Insert shoulder strap buckle into side strap buckle on both sides.
- 4 Insert connected harness and side strap buckles into the sides of the crotch buckle.
- 5 Press button on crotch buckle to release.

⚠ WARNING: Harness straps have loops that can cause strangulation.

- WHEN NOT IN USE, DISCONNECT SHOULDER STRAPS FROM THE WAIST STRAP AND/OR BUCKLE.

⚠ WARNING: USE THIS HARNESS AT ALL TIMES.

⚠ WARNING: Avoid serious injury from falling or sliding out. Always properly adjust and fasten safety harness.

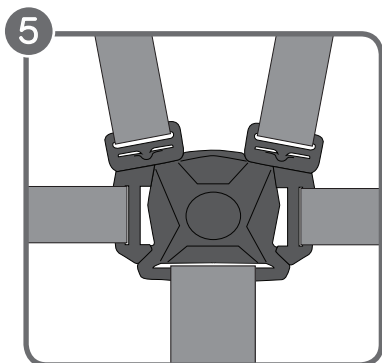
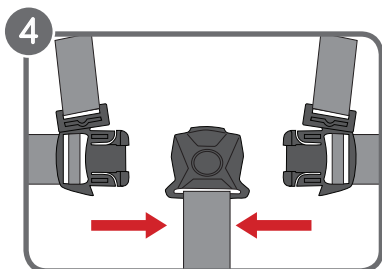



SEAT - RECLINE

- 1 Pinch the clamp behind the seat and slide it down to desired recline.
- 2 Pull seat down on both sides to match recline position of clamp. Reverse steps to return to the upright position.

WEATHER COVER

- 3 If desired, pull the weather cover down and over the seat back mesh. Secure firmly over both sides of the seat. When not in use, roll up the weather cover and fasten it with the elastic loop and barrel provided under the canopy fabric.





SEAT - REMOVAL

- 1 Remove canopy. Unsnap all snaps around frame, including the fold strap.
- 2 On the back of the footwell, remove elastic loops from knobs. Slide fabric off of footwell folding mechanism.
- 3 Pull fabric upward off of seatback.





BASKET REMOVAL

- 1 From the rear of the stroller: Remove velcro straps from hooks located in front of the rear folding area.
- 2 From the front of the stroller: Remove velcro straps from hooks under seat. Unsnap the snaps from the front of the stroller frame and remove basket.





FOLDING

- 1 Remove the child from the seat. Unsnap the red safety straps from the frame. Press the release button located under the cap on the handlebar.
- 2 Pull upwards on the pull strap in the center of the seat with a gentle tug and your stroller will fold. The Auto-lock lever will click into place.



CARE AND MAINTENANCE

To preserve the longevity of your stroller, it is important to perform simple, regular maintenance. From time to time, make sure that the joints and folding areas are still in good condition. If you hear any squeaking or feel tension, you can take your stroller to a local bike shop for added lubrication. All repairs should only be carried out by an authorized dealer.

WASHING

Seat Fabric

- You can machine wash your stroller's seat in cold water with a mild detergent.
- Do not use solvents, caustic or abrasive cleaning materials.
- To minimize shrinkage, simply reattach the seat to the frame to dry.
- Do not press, iron, dry clean, tumble dry or wring the fabric.
- If the seat covers need to be replaced, only use parts from a Baby Jogger Authorized Dealer. They are the only ones that are guaranteed to have been safety tested and designed to fit this seat.

Plastic/Metal Parts

- Wipe clean using a mild soap and warm water.
- You must not remove, dismantle or alter any part of the seat folding mechanism or brakes.

Wheel Care

- The wheels can be cleaned using a damp cloth. They will need to be dried completely with a soft towel or cloth.

STORING

- Sunshine can fade seat fabric and dry out tires, so storing your stroller indoors will prolong its good looks.
- DO NOT store outside.
- Ensure that the stroller is dry before storing for prolonged periods.
- Always store the stroller in a dry environment.
- Store the stroller in a safe place when not in use (i.e. where children cannot play with it).
- DO NOT place heavy objects on top of the stroller.
- DO NOT store the stroller near a direct heat source such as a radiator or fire.

BABY JOGGER LIMITED WARRANTY

Baby Jogger's Limited Warranty:

Baby Jogger warrants that the frame is free of manufacturer defects for the lifetime of the product. Manufacturer's defects include but are not limited to the breaking of welds and frame tube damage. Textile or soft side materials and all other components shall be warranted for one year from the date of purchase (except for tubes and tires). Proof of purchase is required to make a warranty claim and the warranty is only extended to the original purchaser.

THIS WARRANTY DOES NOT COVER:

- Normal wear and tear
- Corrosion or rust
- Incorrect assembly, or the installation of third party parts or accessories not compatible with the original design
- Accidental or intentional damage, abuse or neglect.
- Commercial use
- Improper storage/care of the unit

This warranty specifically excludes claims for indirect, incidental, or consequential damages. The implied warranties of merchantability and fitness for a particular purpose is according to the specific warranty period for this model unit at time of purchase. Some states do not allow the exclusion or limitation of incidental or consequential damages, so the above limitations or exclusions may not apply to you. This warranty gives you specific legal rights, and you may also have other rights which vary from state to state. To know what your legal rights are in your state, consult your local or state consumer affairs office or your State's Attorney General.

If your stroller was purchased outside of the United States, please contact the distributor in the country nearest you. Their contact information can be found on our website at <http://www.babyjogger.com/retailers/#international>. Claims for warranty outside of the country in which the product was purchased may incur shipping charges.



NOTE: When contacting Baby Jogger regarding your stroller, please have your stroller's serial number and manufacturing date ready. Standing behind the stroller, the serial number can be found on the outer upright bar above the right rear wheel.

IN AUSTRALIA CONTACT:

Call: 1300661885
Fax: 0398731433
Mail: The Amazing Baby Company
11 Maurice Court
Nunawading, Victoria 3131
Australia

IN NEW ZEALAND CONTACT:

Call: (64) 033387613
Fax: (64) 033387615
Mail: Baby First Limited
10 Moncur Place
Middleton
Christchurch, 8024
New Zealand

Distributed in Australia By:

The Amazing Baby Company

11 Maurice Court • Nunawading VIC 3131 • Australia

T: 1300.661.885 • F: 03.9873.1433

www.theamazingbabycompany.com.au

Distributed in New Zealand By:

Baby First Limited

10 Moncur Place • Middleton Christchurch, 8024 • New Zealand

T: (64) 03.338.7613 • F: (64) 03 338 7615

www.babyfirst.co.nz



Baby Jogger, LLC

8575 Magellan Parkway, Suite 1000 • Richmond, VA 23227

T: 800.241.1848 • F: 804.262.6277 • www.babyjogger.com