

Panasonic®

Operating Instructions

Compact Stereo System

Model No. **SC-HC29DB**
SC-HC29



Thank you for purchasing this product.

For optimum performance and safety, please read these instructions carefully.

Please keep this manual for future reference.

The installation instructions are on page 16.

Please read these instructions carefully before installing.

“EB” indicates the United Kingdom model.

These operating instructions are applicable for models SC-HC29DB and SC-HC29.

Unless otherwise indicated, illustrations in these operating instructions are of SC-HC29DB. Your system and the illustrations can look differently.



**CLASS 1
LASER PRODUCT**

Bottom of product

Product Identification Marking is located on the bottom of the unit.

Table of contents

Safety precautions	2
Caution for AC mains lead	3
Supplied accessories	3
Making the connections	4
Preparing the remote control	4
Overview of controls	5
Preparing the media	6
One-Touch Connection (NFC)	7
Media playback	7
Radio	9
DAB/DAB+	10
Clock and timers	11
Sound effects	12
External equipment	12
Others	12
Maintenance	12
Troubleshooting	13
Specifications	15
Attaching the unit to a wall (optional)	16
About Bluetooth®	17
Licenses	17
Sales and Support Information	17
Limited Warranty (Australia)	18

Safety precautions

WARNING!

Unit

- To reduce the risk of fire, electric shock or product damage,
 - Do not expose this unit to rain, moisture, dripping or splashing.
 - Do not place objects filled with liquids, such as vases, on this unit.
 - Use only the recommended accessories.
 - Do not remove covers.
 - Do not repair this unit by yourself. Refer servicing to qualified service personnel.
 - Do not let metal objects fall inside this unit.
- For the United Kingdom and Ireland**
 - To prevent injury, this apparatus must be securely attached to the wall in accordance with the installation instructions.

AC mains lead

- The mains plug is the disconnecting device. Install this unit so that the mains plug can be unplugged from the socket outlet immediately.

CAUTION!

Unit

- To reduce the risk of fire, electric shock or product damage,
 - Do not install or place this unit in a bookcase, built-in cabinet or in another confined space. Ensure this unit is well ventilated.
 - Do not obstruct this unit's ventilation openings with newspapers, tablecloths, curtains, and similar items.
 - Do not place sources of naked flames, such as lighted candles, on this unit.
- For Asia and the Middle East**
 - This unit is intended for use in tropical climates.
- For others**
 - This unit is intended for use in moderate climates.
- This unit may receive radio interference caused by mobile telephones during use. If such interference occurs, please increase separation between this unit and the mobile telephone.
- This unit utilizes a laser. Use of controls or adjustments or performance of procedures other than those specified herein may result in hazardous radiation exposure.

Battery

- Danger of explosion if battery is incorrectly replaced. Replace only with the type recommended by the manufacturer.
- When disposing the batteries, please contact your local authorities or dealer and ask for the correct method of disposal.
- Do not heat or expose to flame.
- Do not leave the battery(ies) in a car exposed to direct sunlight for a long period of time with doors and windows closed.
- Do not break open or short-circuit the battery.
- Do not charge the alkaline or manganese battery.
- Do not use the battery if the cover has peeled off.
- Remove the battery if you do not use the remote control for a long period of time. Keep in a cool, dark area.

Caution for AC mains lead

(For the AC mains plug of three pins)

For your safety, please read the following text carefully.

This appliance is supplied with a moulded three pin mains plug for your safety and convenience. A 5-ampere fuse is fitted in this plug. Should the fuse need to be replaced please ensure that the replacement fuse has a rating of 5-ampere and that it is approved by ASTA or BSI to BS1362.

Check for the ASTA mark  or the BSI mark  on the body of the fuse.

If the plug contains a removable fuse cover you must ensure that it is refitted when the fuse is replaced. If you lose the fuse cover the plug must not be used until a replacement cover is obtained. A replacement fuse cover can be purchased from your local dealer.

Before use

Remove the connector cover.

How to replace the fuse

The location of the fuse differ according to the type of AC mains plug (figures A and B). Confirm the AC mains plug fitted and follow the instructions below. Illustrations may differ from actual AC mains plug.

1. Open the fuse cover with a screwdriver.

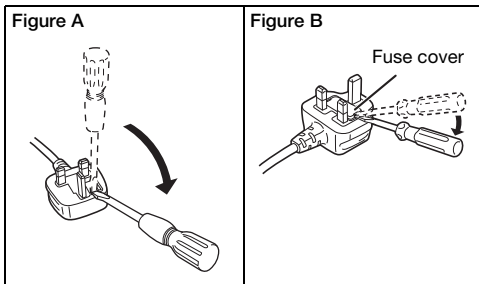

2. Replace the fuse and close or attach the fuse cover.

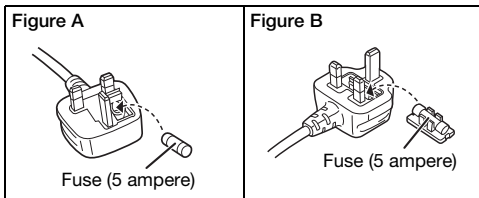

Supplied accessories

Check and identify the supplied accessories.

For the United Kingdom and Ireland

Use numbers indicated in parentheses when asking for replacement parts. (Product numbers correct as of February 2014. These may be subject to change.)

- ☐ **For the United Kingdom and Ireland**
1 AC mains lead
(K2CT2YY00097)

- ☐ **For Australia and New Zealand**
1 AC mains lead

- ☐ **For Asia and the Middle East**
3 AC mains leads

- ☐ **For Australia and New Zealand**
1 AM loop antenna

- ☐ **For the United Kingdom and Ireland**
1 DAB antenna
(RFA3425)



For others

- 1 FM indoor antenna



- ☐ 1 Remote control
(N2QAYB000944)
- ☐ 1 Remote control battery

For the United Kingdom and Ireland

Wall mount kit

- ☐ 2 Wall mount brackets
(RSC1262)
- ☐ 1 Safety holder
(RSC1266)
- ☐ 1 Screw
(XTB3+8JFJK-J)



Making the connections

Connect the AC mains lead only after all the other connections have been made.

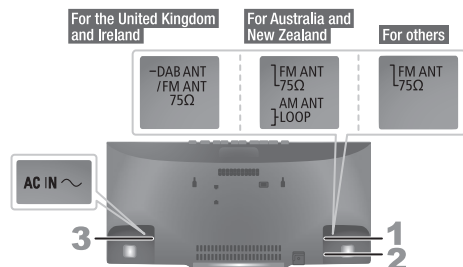

- 1** **For the United Kingdom and Ireland**
Connect the DAB antenna.
 Be sure to tighten fully the nut.

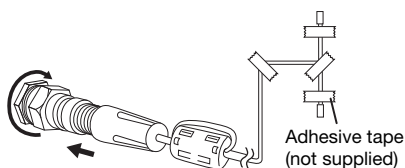

Do not use any other DAB antenna except the supplied one.

For others

Connect the FM indoor antenna.

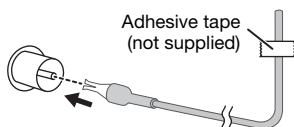

- 2** **For Australia and New Zealand**
Connect the AM loop antenna.
 Stand the antenna up on its base until it clicks.

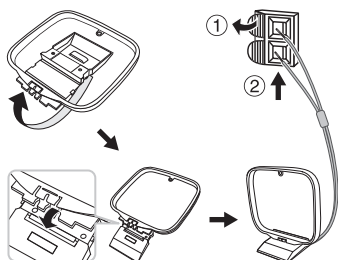

- 3** **Connect the AC mains lead.**

(For the AC mains plug of three pins)
READ THE "Caution for AC mains lead" BEFORE CONNECTION.

To household mains socket

Do not use any other AC mains lead except the supplied one.

Conserving power

The system consumes a small amount of power (→ "Specifications") when it is in standby mode. Disconnect the power supply if you do not use the system.

Some settings will be lost after you disconnect the system. You have to set them again.

Note:

- These speakers do not have magnetic shielding. Do not put them near TVs, PCs or other equipment easily influenced by magnetism.
- Tape the DAB or FM antenna to a wall with the least amount of interference.
- Use a DAB or FM outdoor antenna if the reception is poor.

Preparing the remote control

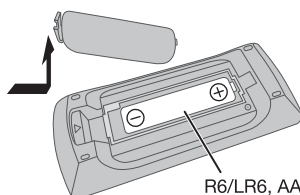

Use alkaline or manganese battery.

Install the battery so that the poles (+ and -) align with those in the remote control.

Overview of controls

Do the procedures with the remote control. You can also use the buttons on the main unit if they are the same.

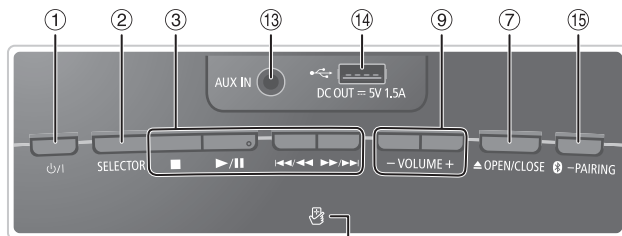
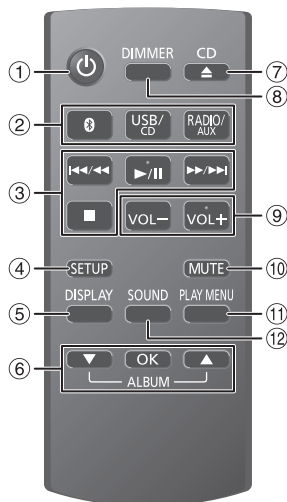

Top view

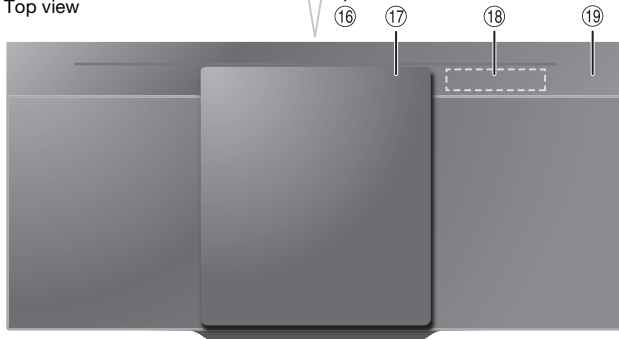

- ① **Standby/on switch** [⏻], [⏻/⏮]
Press to switch the unit from on to standby mode or vice versa. In standby mode, the unit is still consuming a small amount of power.

- ② **Select the audio source**
On the remote control:
Press the corresponding button to select the source.
On the main unit:
CD → BLUETOOTH → USB → DAB/DAB+*1 → FM
← AUX ← AM*2 ←

*1 For the United Kingdom and Ireland

*2 For Australia and New Zealand

- ③ Basic playback control
- ④ View the setup menu
- ⑤ View the content information
- ⑥ Select or confirm the option
- ⑦ Open or close the sliding door
- ⑧ **Decrease the brightness of the display panel**
To cancel, press the button again.
- ⑨ Adjust the volume level

- ⑩ **Mute the sound**
To cancel, press the button again.
“MUTE” is also cancelled when you adjust the volume or when you switch off the system.
- ⑪ View the play menu
- ⑫ Select the sound effects
- ⑬ AUX IN terminal
- ⑭ USB port (←) DC OUT terminal (→ “Charging a portable device”)
- ⑮ **Select “BLUETOOTH” as the audio source**
To start Bluetooth® pairing, press and hold the button.
- ⑯ NFC touch area
- ⑰ Sliding door
- ⑱ Display panel
- ⑲ **Remote control sensor**
Distance: Within approximately 7 m
Angle: Approximately 20° up and down, 30° left and right

Preparing the media

Disc

- 1 Press [USB/CD] to select "CD".
- 2 Press [CD ▲] (main unit: [▲ OPEN/CLOSE]) to open the sliding door.
Put in a disc with the label facing towards you.

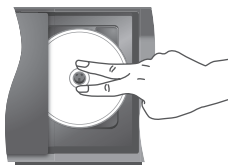

- 3 Press [CD ▲] (main unit: [▲ OPEN/CLOSE]) again to close the sliding door.
Keep fingers away from the sliding door when it is closing.

USB

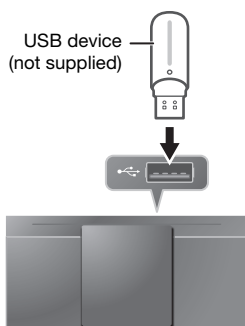

Press [USB/CD] to select "USB".

Note:

Do not use a USB extension cable. The system cannot recognise USB device connected through a cable.

Bluetooth®

You can connect and play an audio device wirelessly through Bluetooth®.

Preparation

- Switch on the Bluetooth® feature of the device and put the device near the system.
- Read the operating instructions of the device for details.

Pairing a device

Preparation

If this system is connected to a Bluetooth® device, disconnect it (➡ "Disconnecting a device").

- 1 Press [Ⓜ] to select "BLUETOOTH".
If "PAIRING" is shown, continue with step 4.
- 2 Press [PLAY MENU] to select "PAIRING".
Or press and hold [Ⓜ –PAIRING] on the main unit until "PAIRING" is shown. Continue with step 4.
- 3 Press [▲, ▼] to select "OK? YES" and then press [OK].
"PAIRING" is shown.
To cancel, select "OK? NO".
- 4 Select "SC-HC29" from the Bluetooth® menu of the device.
If prompted for a passkey, input "0000".
The device connects with this system automatically after pairing is complete.
The name of the connected device is shown for a few seconds.

Note:

You can pair up to 8 devices with this system. If a 9th device is paired, the device that has not been used for the longest time will be replaced.

Connecting a device

Preparation

If this system is connected to a Bluetooth® device, disconnect it (➡ "Disconnecting a device").

- 1 Press [Ⓜ] to select "BLUETOOTH".
"BLUETOOTH READY" is shown.
- 2 Select "SC-HC29" from the Bluetooth® menu of the device.
The name of the connected device is shown for a few seconds.
- 3 Start playback on the device.

Note:

- A device must be paired to connect.
- This system can only connect to one device at a time.
- When "BLUETOOTH" is selected as the source, this system will automatically try to connect to the last connected device.

Disconnecting a device

- 1 Press [Ⓜ] to select "BLUETOOTH".
- 2 Press [PLAY MENU] repeatedly to select "DISCONNECT?".
- 3 Press [▲, ▼] to select "OK? YES" and then press [OK].
"BLUETOOTH READY" is shown.
To cancel, select "OK? NO".

Using the main unit

Press and hold [Ⓜ –PAIRING] until "PAIRING" is shown.

Note:

A device is disconnected when you:

- Select a different source.
- Move the device out of the maximum range.
- Disable the Bluetooth® transmission of the device.
- Switch off the system or the device.

One-Touch Connection (NFC)

For NFC-compatible Bluetooth® devices (Android™ devices) only
Simply by touching an NFC (Near Field Communication)-compatible Bluetooth® device on the system, you can complete all preparations, from registering a Bluetooth® device to establishing a connection.

Android™ device version lower than 4.1 requires the installation of the “Panasonic Music Streaming” app (free of charge).

①

Enter “Panasonic Music Streaming” in the search box of Google Play™ to search and then select “Panasonic Music Streaming”.

②

Start the app.

– Follow the instructions to complete the settings.

– Make sure to use the latest version of the app.

Preparation
Switch on the NFC feature of the device.

- 1 Press [NFC] to select “BLUETOOTH”.
- 2 Touch and hold the device on the NFC touch area of the main unit [NFC].

– Hold the device until it beeps, vibrates or displays a pop-up window, and then move the device away from the system.

– Once the registration and connection of the device is complete, the name of the connected device is shown on the system for a few seconds.

– When the connection is not established even if the device has touched the NFC touch area, change its touching position. The connection may improve if you use the “Panasonic Music Streaming” app.

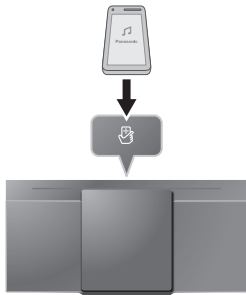

- 3 Start playback on the device.

Note:

- While connected, you can connect another device by touching and holding it on the NFC touch area of the main unit. The previous device will be disconnected automatically.
- Depending on the device:
 - The one-touch connection may not work.
 - The position of the NFC touch area of the device may be different.
 - When the connection is established, playback may start automatically.

Media playback

The following marks indicate the availability of the feature.

CD:

CD-R/RW in CD-DA format or with MP3 files.

USB:

USB device with MP3 files.

BLUETOOTH:

Bluetooth® device.

Basic playback

CD USB BLUETOOTH	
Play	Press [▶/].
Stop	Press [■]. <div>USB The position is memorised. “RESUME” is shown. Press again to stop fully.</div>
Pause	Press [▶/]. Press again to continue playback.
Skip	Press [◀◀/▶▶] or [▶▶/▶▶] to skip track. <div>CD USB Press [▲, ▼] to skip MP3 album.</div>
Search	Press and hold [◀◀/▶▶] or [▶▶/▶▶].

Note:
Depending on the Bluetooth® device, some operations may not work.

Viewing available information

CD USB BLUETOOTH

You can view the available information on the display panel.

Press [DISPLAY].

- Note:**
- Maximum characters that can be shown:

CD USB : approximately 32

BLUETOOTH : approximately 16
 - This system supports ver. 1.0, 1.1 and 2.3 ID3 tags.
 - Text data that the system does not support can show differently.
 - Example: MP3 album and track number display.

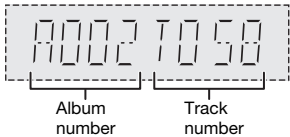

Play menu

CD USB

- 1 Press [PLAY MENU] repeatedly to select "PLAYMODE" or "REPEAT".
- 2 Press [▲, ▼] to select the setting and then press [OK].

PLAYMODE

OFF PLAYMODE	Cancel the setting.
1-TRACK 1	Play one selected track. Press [◀◀/◀◀] or [▶▶/▶▶] to select the track.
1-ALBUM 1	Play one selected MP3 album. Press [▲, ▼] to select the MP3 album.
RANDOM RND	Play all tracks randomly.
1-ALBUM RANDOM 1 RND	Play all tracks in one selected MP3 album randomly. Press [▲, ▼] to select the MP3 album.

REPEAT

OFF REPEAT	Cancel the setting.
ON REPEAT 	Repeat playback.

Note:

- During random playback, you cannot skip to tracks which have been played.
- The setting is cancelled when you open the sliding door.

Link mode

BLUETOOTH

You can change the link mode to suit the connection type.

Preparation

If this system is connected to a Bluetooth® device, disconnect it (➡ "Disconnecting a device").

- 1 Press [PLAY MENU] repeatedly to select "LINK MODE".
- 2 Press [▲, ▼] to select the mode and then press [OK].

MODE 1	Emphasis on connectivity.
MODE 2	Emphasis on sound quality.

Note:

- The default setting is "MODE 2".
- Select "MODE 1" if the sound is interrupted.

Input level

BLUETOOTH

You can change the input level setting if the sound input level of the Bluetooth® transmission is too low.

- 1 Press [PLAY MENU] repeatedly to select "INPUT LEVEL".
- 2 Press [▲, ▼] to select the level and then press [OK].

LEVEL 0 ↔ LEVEL +1 ↔ LEVEL +2

Note:

- The default setting is "LEVEL 0".
- Select "LEVEL 0" if the sound is distorted.

Note on disc

- This system can play CD-R/RW with CD-DA or MP3 format content.
- Before playback, finalise the disc on the device it was recorded on.
- Some CD-R/RW cannot be played because of the condition of the recording.

Note on USB device

- This system does not guarantee connection with all USB devices.
- This system supports USB 2.0 full speed.
- This system can support USB devices of up to 32 GB.
- Only FAT 12/16/32 file system is supported.

Note on MP3 file

- Files are defined as tracks and folders are defined as albums.
- Tracks must have the extension ".mp3" or ".MP3".
- Tracks will not necessarily be played in the order you recorded them.
- Some files can fail to work because of the sector size.

MP3 file on disc

- This system can access up to:
 - 255 albums (including root folder)
 - 999 tracks
 - 20 sessions
- Disc must conform to ISO9660 level 1 or 2 (except for extended formats).

MP3 file on USB device

- This system can access up to:
 - 800 albums (including root folder)
 - 8000 tracks
 - 999 tracks in one album

Radio

Preparation

For Australia and New Zealand

Press [RADIO/AUX] to select “FM” or “AM”.

For others

Press [RADIO/AUX] to select “FM”.

Manual tuning

- 1 Press [PLAY MENU] repeatedly to select “TUNEMODE”.
- 2 Press [▲, ▼] to select “MANUAL” and then press [OK].
- 3 Press [◀◀/▶▶] or [▶▶/▶▶] to tune in to the station.
To tune automatically, press and hold the button until the frequency starts changing quickly.
“STEREO” is shown when a stereo broadcast is being received.

Memory presetting

You can preset up to 30 FM stations.

For Australia and New Zealand

You can preset up to 15 AM stations.

Automatic presetting

- 1 Press [PLAY MENU] to select “A.PRESET”.
- 2 Press [▲, ▼] to select “LOWEST” or “CURRENT” and then press [OK].
The tuner presets all the stations it can receive into the channels in ascending order.
To cancel, press [■].

LOWEST	Tuning begins from the lowest frequency.
CURRENT	Tuning begins from the current frequency.

Manual presetting

- 1 Press [PLAY MENU] repeatedly to select “TUNEMODE”.
- 2 Press [▲, ▼] to select “MANUAL” and then press [OK].
- 3 Press [◀◀/▶▶] or [▶▶/▶▶] to tune in to the station.
- 4 Press [OK].
- 5 Press [▲, ▼] to select a preset number and then press [OK].
Do steps 3 through 5 again to preset more stations.
The new station replaces any station that occupies the same preset number.

Selecting a preset station

- 1 Press [PLAY MENU] repeatedly to select “TUNEMODE”.
- 2 Press [▲, ▼] to select “PRESET” and then press [OK].
- 3 Press [◀◀/▶▶] or [▶▶/▶▶] to select the preset station.

Improving the sound quality

When “FM” is selected

- 1 Press [PLAY MENU] repeatedly to select “FM MODE”.
- 2 Press [▲, ▼] to select “MONO” and then press [OK].
To cancel, select “STEREO”.
“MONO” is also cancelled when you change the frequency.

To memorise the setting

Continue with step 4 of “Manual presetting”.

Checking the signal status

When “FM” is selected

Press [DISPLAY].

FM	The FM signal is in monaural. The system is not tuned in to a station.
FM ST	The FM signal is in stereo.
FM MONO	“MONO” is selected as the “FM MODE”.

AM allocation setting

For Australia and New Zealand

This system can also receive AM broadcasts allocated in 10 kHz steps.

- 1 Press [RADIO/AUX] to select “AM”.
- 2 Press and hold [SELECTOR] on the main unit.

After a few seconds, the display panel shows the current minimum radio frequency. Release the button when the minimum frequency changes.

- To go back to the initial setting, do the above steps again.
- Preset frequencies are erased after you change the setting.

DAB/DAB+

For the United Kingdom and Ireland

Preparation

Press [RADIO/AUX] to select "DAB/DAB+".

Note:

If you select "DAB/DAB+" for the first time, the system will tune automatically.

Manual tuning

- 1 Press [PLAY MENU] repeatedly to select "MANUAL SCAN".
- 2 Press [▲, ▼] to select the frequency block and then press [OK].
If no station is detected, "SCAN FAILED" is shown.
Adjust the antenna and try again.

To tune automatically

- 1 Press [PLAY MENU] to select "AUTOSCAN" and then press [OK].
"START?" is shown.
- 2 Press [OK] to start tuning.
"DAB AUTO SCAN" is shown.
If no station is detected, "SCAN FAILED" is shown.
Do manual tuning.

Note:

Preset frequencies are erased after you do automatic tuning.

Memory presetting

You can preset up to 20 stations.

- 1 Press [PLAY MENU] repeatedly to select "TUNEMODE".
- 2 Press [▲, ▼] to select "STATION" and then press [OK].
- 3 Press [◀◀/▶▶] or [▶▶/▶▶] to tune in to the station.
- 4 Press [OK].
- 5 Press [▲, ▼] to select a preset number and then press [OK].
Do steps 3 through 5 again to preset more stations.
The new station replaces any station that occupies the same preset number.

Note:

You cannot preset a station when the station is not broadcasting or when you have selected a secondary service.

Selecting a preset station

- 1 Press [PLAY MENU] repeatedly to select "TUNEMODE".
- 2 Press [▲, ▼] to select "PRESET" and then press [OK].
- 3 Press [◀◀/▶▶] or [▶▶/▶▶] to select the preset station.

Secondary service

You can listen to secondary services when "▼" is shown.

- 1 Press [PLAY MENU] repeatedly to select "DAB SECONDARY".
- 2 Press [▲, ▼] to select the secondary service and then press [OK].
To cancel, select "PRIMARY".

Note:

The setting is cancelled when you select other stations.

Viewing available information

You can view the following information on the display panel:

- Information about the DAB broadcast
- Programme type
- Ensemble label
- Frequency
- Time

Press [DISPLAY].

Checking the signal quality

You can check the signal quality when adjusting the antenna.

- 1 Press [PLAY MENU] repeatedly to select "SIGNAL QUALITY".
- 2 Press [OK].
The frequency block followed by the reception quality is shown.
To select other frequency blocks, press [▲, ▼].

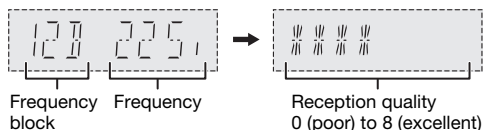

- 3 Press [OK] again to exit.

Automatic clock adjustment

You can set the clock to update automatically.

- 1 Press [PLAY MENU] repeatedly to select "AUTO CLOCK ADJ".
- 2 Press [▲, ▼] to select "ON ADJUST" and then press [OK].
To cancel, select "OFF ADJUST".

Play timer

(Except for Bluetooth® source)

You can set the timer to come on at a certain time to wake you up.

- Preparation**
Set the clock.

1 Press [SETUP] repeatedly to select “TIMER ADJ.”.

2 Press **[▲, ▼]** to set the start time and then press **[OK]**.

3 Do step 2 again to set the end time.

- 4** Press **[▲, ▼]** to select the source you want to play and then press **[OK]**.

To start the timer

1 Press [SETUP] repeatedly to select “TIMER SET”.

- 2 Press **[▲, ▼]** to select “SET” and then press **[OK]**.
“⓪” is shown.
To cancel, select “OFF”.
The system must be switched off for the timer to operate.

To check the setting

Press [SETUP] repeatedly to select "TIMER ADJ" and then press [OK].
In standby mode, press [DISPLAY] two times.

Note:

- The timer starts at a low volume and increases gradually to the preset level.
- The timer comes on at the set time every day if the timer is on.
- If you switch off the system and then switch on again while a timer is in operation, the timer will not stop at the end time.

Sound effects

- 1 Press [SOUND] repeatedly to select the sound effect.
- 2 Press [▲, ▼] to select the setting and then press [OK].

PRESET EQ	"HEAVY", "SOFT", "CLEAR", "VOCAL" or "FLAT"
BASS	-4 to +4
TREBLE	-4 to +4
D.BASS	<u>"ON D.BASS"</u> or "OFF D.BASS"
SURROUND	<u>"ON SURROUND"</u> or "OFF SURROUND"

Note:

The default setting is underlined. Changed settings will be kept until it is changed again, unless otherwise indicated.

External equipment

You can play music from a portable audio equipment.

Preparation

- Switch off the equaliser (if any) of the portable audio equipment to prevent sound distortion.
- Decrease the volume of the system and the portable audio equipment before you connect or disconnect the portable audio equipment.

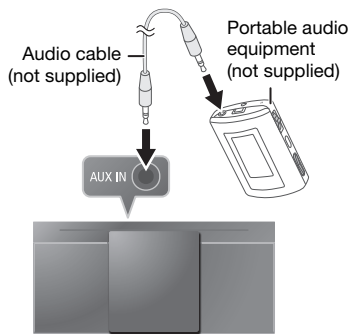

- 1 Connect the portable audio equipment.
Plug type: Ø 3.5 mm stereo (not supplied)
- 2 Press [RADIO/AUX] to select "AUX".
- 3 Play the portable audio equipment.

To adjust the input level

- 1 Press [SOUND] repeatedly to select "INPUT LEVEL".
- 2 Press [▲, ▼] to select "NORMAL" or "HIGH" and then press [OK].

Note:

- The default setting is "NORMAL".
- Select "NORMAL" if the sound is distorted during "HIGH" input level.
- Read the operating instructions of the portable audio equipment for details.
- Components and cables are sold separately.

Others

Auto off

This system automatically switches off when you do not use it for approximately 20 minutes.

- 1 Press [SETUP] repeatedly to select "AUTO OFF".
- 2 Press [▲, ▼] to select "ON" and then press [OK].
To cancel, select "OFF".

Note:

- This function does not work when you are in radio source or when a Bluetooth® device is connected.

For the United Kingdom and Ireland

This function does not work when you are in DAB/DAB+ source.

Bluetooth® standby

This function automatically switches on the system when you establish a Bluetooth® connection from a paired device.

- 1 Press [SETUP] repeatedly to select "BLUETOOTH STANDBY".
- 2 Press [▲, ▼] to select "ON" and then press [OK].
To cancel, select "OFF".

Charging a portable device

This system can supply power to a portable device, such as Android™ smartphone, connected to the USB port.

Note:

- Use a cable compatible with the device.
- Use the charger supplied with the device if power is not supplied to the device.
- Do not use a cable or connect a device that exceeds the rated value of 5 V, 1.5 A.
- Examine the screen of the device to check if charging is complete. Disconnect the device after charging.
- Depending on the device, power may not be supplied to it.
- Read the operating instructions of the device for details.

Checking the software version

- 1 Press [SETUP] repeatedly to select "SW VER." and then press [OK].
The software version is shown.
- 2 Press [OK] again to exit.

Maintenance

To clean this system, wipe with a soft, dry cloth.

- Never use alcohol, paint thinner or benzine to clean this system.
- Before using chemically treated cloth, read the instructions that came with the cloth carefully.

Troubleshooting

Before requesting service, make the following checks. If you are in doubt about some of the check points, or if the solutions indicated do not solve the problem, consult your dealer for instructions.

Common problems

The unit does not work.

- The safety device has been activated. Do the following:
 1. Press [ψ /I] on the main unit to switch the unit to standby mode. If the unit does not switch to standby mode,
 - Press and hold the button for a minimum of 10 seconds. Or,
 - Disconnect the AC mains lead and connect it again.
 2. Press [ψ /I] again to switch on the unit. If the problem persists, consult your dealer.

No operations can be done with the remote control.

- Examine that the battery is installed correctly.

Sound is distorted or no sound.

- Adjust the volume of the system.
- Switch off the system, determine and correct the cause, and then switch on again. It can be caused by straining of the speakers through excessive volume or power, and when using the system in a hot environment.

A humming sound can be heard during playback.

- An AC mains lead or fluorescent light is near the cables. Keep other appliances and cords away from the cables of this system.

Noise is heard.

- Depending on the device, noise may be heard if the device is connected to the AUX IN and DC OUT terminals at the same time. Disconnect the cable from the DC OUT terminal.

Disc

Display not shown correctly.

Playback does not start.

- You have not put in the disc correctly. Put it in correctly.
- Disc is dirty. Clean the disc.
- Replace the disc if it is scratched, warped, or non-standard.
- There is condensation. Let the system dry for 1 to 2 hours.

USB

The USB device or the contents in it cannot be read.

- The format of the USB device or the contents in it are not compatible with the system.
- USB devices with storage capacity of more than 32 GB cannot work in some conditions.

Slow operation of the USB device.

- Large content size or large memory USB device takes longer time to read.

The elapsed time shown is different from the actual play time.

- Transfer the data to another USB device or backup the data and reformat the USB device.

Bluetooth®

Pairing cannot be done.

- Check the Bluetooth® device condition.
- The device is out of the 10 m communication range. Move the device nearer to the system.

The device cannot be connected.

- The pairing of the device was unsuccessful. Do pairing again.
- The pairing of the device has been replaced. Do pairing again.
- This system might be connected to a different device. Disconnect the other device and try pairing the device again.

The device is connected but audio cannot be heard through the system.

- For some built-in Bluetooth® devices, you have to set the audio output to "SC-HC29" manually. Read the operating instructions of the device for details.

Sound from the device is interrupted.

- The device is out of the 10 m communication range. Move the device nearer to the system.
- Remove any obstacle between the system and the device.
- Other devices that use the 2.4 GHz frequency band (wireless router, microwaves, cordless phones, etc.) are interfering. Move the device nearer to the system and distance it from the other devices.
- Select "MODE 1" for stable communication.

The one-touch connection (NFC) is not working.

- Make sure the system and the NFC feature of the device are switched on.
- Touch and hold the device on the NFC touch area of this system again.

Playback image and sound are not synchronised.

- Restart the playback app of the device.
- Connect the device to the system with an audio cable (not supplied).

Radio, DAB/DAB+

Sound is distorted.

- Use an optional outdoor antenna. The antenna should be installed by a competent technician.

A beat sound is heard.

- Switch off the TV or move it away from the system.
- Move mobile telephones away from the system if the interference is apparent.

A low hum is heard during AM broadcasts.

- Move the antenna away from other cables and cords.

Main unit displays

“--:--”

- You connected the AC mains lead for the first time or there was a power failure recently. Set the clock.

“ADJUST CLOCK”

- The clock is not set. Adjust the clock.

“ADJUST TIMER”

- The play timer is not set. Adjust the play timer.

“AUTO OFF”

- The system has not been used for 20 minutes and will switch off within a minute. To cancel, press any button.

“ERROR”

- An incorrect operation was done. Read the instructions and try again.

“F61”

“F77”

- Disconnect the AC mains lead and consult your dealer.

“F70”

- Examine the Bluetooth® device.
- Disconnect the Bluetooth® device. Switch off the system and then switch on again.

“F76”

- There is a problem with the power supply.
- Disconnect the AC mains lead and consult your dealer.

“ILLEGAL OPEN”

- The sliding door is not in a correct position. Switch off the system and then switch on again.

“NODEVICE”

- The USB device is not connected. Examine the connection.

“NO DISC”

- You have not put in a disc.

“NO MEMORY”

- DAB memory presetting has not been done.

“NO PLAY”

- Examine the content. You can only play supported format.
- The system may have a problem. Switch off the system and then switch on again.

“NO SIGNAL”

- The station cannot be received. Adjust the antenna.

“PLAYERERROR”

- You played an unsupported MP3 file. The system will skip that track and play the next one.

“REMOTE 1”

“REMOTE 2”

- The remote control and the main unit are using different codes. Change the code of the remote control.
 - When “REMOTE 1” is shown, press and hold [OK] and [Ⓜ] for a minimum of 4 seconds.
 - When “REMOTE 2” is shown, press and hold [OK] and [USB/CD] for a minimum of 4 seconds.

“SCAN FAILED”

- Stations cannot be received. Adjust the antenna or do manual tuning.

“USB OVER CURRENT ERROR”

- The USB device is using too much power. Disconnect the USB device, switch off the system and then switch on again.

“VBR--”

- The system cannot show the remaining play time for variable bit rate (VBR) tracks.

Remote control code

When other Panasonic equipment responds to the remote control of this system, change the remote control code for this system.

Preparation

Press [USB/CD] to select “CD”.

To set the code to “REMOTE 2”

- 1 Press and hold [SELECTOR] on the main unit and [USB/CD] on the remote control. “REMOTE 2” is shown.
- 2 Press and hold [OK] and [USB/CD] for a minimum of 4 seconds.

To set the code to “REMOTE 1”

- 1 Press and hold [SELECTOR] on the main unit and [Ⓜ] on the remote control. “REMOTE 1” is shown.
- 2 Press and hold [OK] and [Ⓜ] for a minimum of 4 seconds.

System memory reset

Reset the memory when the following situations occur:

- There is no response when buttons are pressed.
- You want to clear and reset the memory contents.

- 1 Disconnect the AC mains lead.
- 2 While you press and hold [⏻] on the main unit, connect the AC mains lead again. Continue to press and hold the button until “-----” is shown.
- 3 Release [⏻].

All the settings are set back to the factory preset. It is necessary to set the memory items again.

Specifications

Amplifier section

RMS output power stereo mode	
Front Ch (both ch driven)	10 W per channel (8 Ω), 1 kHz, 10% THD
Total RMS stereo mode power	20 W
For Asia and the Middle East	
PMPO output power	200 W

Tuner, terminals section

Preset memory	FM 30 stations
For Australia and New Zealand	AM 15 stations
Frequency modulation (FM)	
Frequency range	87.50 MHz to 108.00 MHz (50 kHz step)
Antenna terminals	75 Ω (unbalanced)
For Australia and New Zealand	
Amplitude modulation (AM)	
Frequency range	522 kHz to 1629 kHz (9 kHz step)
	520 kHz to 1630 kHz (10 kHz step)
AUX input	
Terminal	Stereo, 3.5 mm jack

DAB section

For the United Kingdom and Ireland	
DAB memories	20 channels
Frequency band (wavelength)	
Band III (Europe)	5A to 13F (174.928 MHz to 239.200 MHz)
Sensitivity *BER 4x10 ⁻⁴	
Min requirement	-98 dBm
DAB external antenna	
Terminal	F - Connector (75 Ω)

Disc section

Disc played (8 cm or 12 cm)	
	CD, CD-R/RW (CD-DA, MP3*)
Pick up	
Wavelength	790 nm (CD)

USB section

USB port	
USB standard	USB 2.0 full speed
Media file format support	MP3 (*.mp3)
USB device file system	FAT12, FAT16, FAT32
USB port power	DC OUT 5 V, 1.5 A

Bluetooth® section

Version	Bluetooth® Ver. 2.1 + EDR
Class	Class 2
Supported profiles	A2DP, AVRCP
Operating frequency	2.4 GHz band, FH-SS
Operation distance	10 m line of sight

Speaker section

Speaker unit(s)	
Full range	8 cm cone type x 1 per channel
Impedance	8 Ω

General

Power supply	
For Asia and the Middle East	AC 110 V to 240 V, 50/60 Hz
For others	AC 220 V to 240 V, 50 Hz
Power consumption	22 W
Dimensions (W x H x D)	400 mm x 197 mm x 107 mm
Mass	1.9 kg
Operating temperature range	0°C to +40°C
Operating humidity range	35% to 80% RH (no condensation)

Power consumption in standby mode*2	
	0.2 W (approximate)
Power consumption in standby mode*2	
(With "BLUETOOTH STANDBY" set to "ON")	
	0.3 W (approximate)

- Note:
- Specifications are subject to change without notice.
 - Mass and dimensions are approximate.
 - Total harmonic distortion is measured by the digital spectrum analyzer.
- *1 MPEG-1 Layer 3, MPEG-2 Layer 3
- *2 Power consumption in standby mode is measured with USB device disconnected from the unit before switching to standby mode.

Attaching the unit to a wall (optional)

For the United Kingdom and Ireland

You can use the supplied wall mount brackets to attach this unit to the wall.

Panasonic cannot be held responsible for any property damage and/or serious injury, including death resulting from improper installation or incorrect handling.

CAUTION!

- The installation should be done by a competent installation specialist.
- Keep the wall mount brackets, the safety holder and the screws out of reach of children to prevent swallowing.
- Make sure the screws, the cord and the wall can support the weight of more than 30 kg.

Preparation

Disconnect the antenna(s) and the AC mains lead.

Installation accessories

Supplied accessories

- ☐ 2 Wall mount brackets
- ☐ 1 Safety holder
- ☐ 1 Screw

Additional accessories (commercially available)

- ☐ 5 Screws
- ☐ 1 Screw eye
- ☐ 1 Cord (with a diameter of about 1.5 mm)

Installation instructions

1 Detach the pedestal of the unit.

Put a protection layer below the unit to prevent scratches.

Remove the screw from the bottom of the unit.

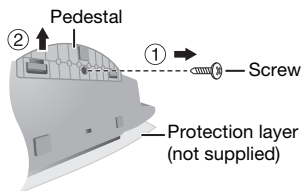

2 Measure and mark the position of the wall mount brackets on the wall.

Make sure the space on the wall is more than 60 cm (width) by 40 cm (height).

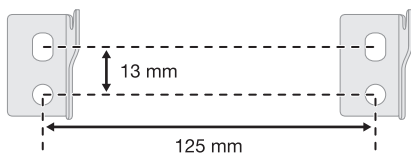

3 Fix the wall mount brackets to the wall.

Use a level to align the wall mount brackets.

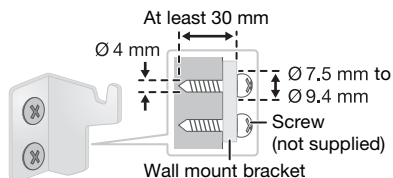

4 Fix the safety holder to the unit with the supplied screw.

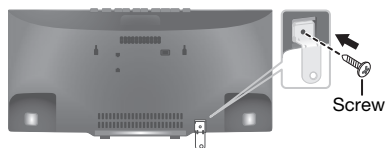

5 Attach a cord to the unit to prevent the unit from falling.

Bend the cord twice from the tip, each at 45° and 5 mm apart for it to go through the holes.

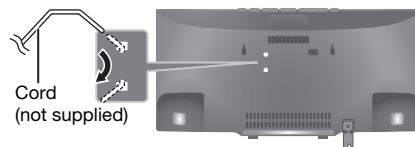

6 Connect the antenna(s) and the AC mains lead (→ "Making the connections").

7 Hook the unit onto the wall mount brackets.

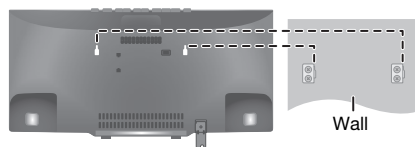

8 Fix the safety holder to the wall.

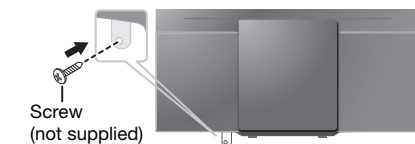

9 Attach the cord to the wall.

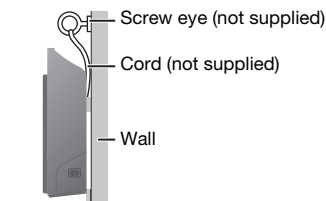

About Bluetooth®

Panasonic cannot be held responsible for data and/or information that can possibly be compromised during a wireless transmission.

Frequency band

- This system uses the 2.4 GHz frequency band.

Certification

- This system conforms to the frequency restrictions and has received certification based on frequency laws. Thus, a wireless permit is not necessary.
- The actions below are punishable by law:
 - Taking apart or modifying the main unit.
 - Removing specification indications.

Restrictions of use

- Wireless transmission and/or usage with all Bluetooth® equipped devices is not guaranteed.
- All devices must conform to standards set by Bluetooth SIG, Inc.
- Depending on the specifications and settings of a device, it can fail to connect or some operations can be different.
- This system supports Bluetooth® security features. But depending on the operating environment and/or settings, this security is possibly not sufficient. Transmit data wirelessly to this system with caution.
- This system cannot transmit data to a Bluetooth® device.

Range of use

- Use this device at a maximum range of 10 m.
- The range can decrease depending on the environment, obstacles or interference.

Interference from other devices

- This system may not function properly and troubles such as noise and sound jumps may arise due to radio wave interference if this unit is located too close to other Bluetooth® devices or the devices that use the 2.4 GHz band.
- This system may not function properly if radio waves from a nearby broadcasting station, etc. is too strong.

Intended usage

- This system is for normal, general use only.
- Do not use this system near an equipment or in an environment that is sensitive to radio frequency interference (example: airports, hospitals, laboratories, etc.).

For Oman

OMAN-TRA
R/1721/14
D090281

Licenses

MPEG Layer-3 audio coding technology licensed from Fraunhofer IIS and Thomson.
The Bluetooth® word mark and logos are owned by the Bluetooth SIG, Inc. and any use of such marks by Panasonic Corporation is under license. Other trademarks and trade names are those of their respective owners.
Google Play and Android are trademarks of Google Inc.

Sales and Support Information

For the United Kingdom and Ireland

Customer Communications Centre

- For customers within the UK: 0844 844 3899
- For customers within Ireland: 01 289 8333
- Monday – Friday 9:00am – 5:00pm (Excluding public holidays).
- For further support on your product, please visit our website: www.panasonic.co.uk

Direct Sales at Panasonic UK

- Order accessory and consumable items for your product with ease and confidence by phoning our Customer Communications Centre Monday – Friday 9:00am – 5:00pm (Excluding public holidays).
- Or go on line through our Internet Accessory ordering application at www.pas-europe.com.
- Most major credit and debit cards accepted.
- All enquiries transactions and distribution facilities are provided directly by Panasonic UK.
- It couldn't be simpler!
- Also available through our Internet is direct shopping for a wide range of finished products. Take a browse on our website for further details.

For the United Kingdom and Ireland

CE1177

Declaration of Conformity (DoC)

Hereby, “Panasonic Corporation” declares that this product is in compliance with the essential requirements and other relevant provisions of Directive 1999/5/EC.

Customers can download a copy of the original DoC to our R&TTE products from our DoC Server:
<http://www.doc.panasonic.de>
Contact to Authorised Representative: Panasonic Marketing Europe GmbH, Panasonic Testing Centre, Winsbergring 15, 22525 Hamburg, Germany

This product is intended for general consumer.
(Category 3)

Limited Warranty (Australia)

Panasonic Warranty

1. The product is warranted for 12 months from the date of purchase. Subject to the conditions of this warranty Panasonic or its Authorised Service Centre will perform necessary service on the product without charge for parts or labour, if in the opinion of Panasonic, the product is found to be faulty within the warranty period.
2. This warranty only applies to Panasonic products purchased in Australia and sold by Panasonic Australia or its Authorised Distributors or Dealers and only where the products are used and serviced within Australia or its territories. Warranty cover only applies to service carried out by a Panasonic Authorised Service Centre and only if valid proof of purchase is presented when warranty service is requested.
3. This warranty only applies if the product has been installed and used in accordance with the manufacturer's recommendations (as noted in the operating instructions) under normal use and reasonable care (in the opinion of Panasonic). The warranty covers normal domestic use only and does not cover damage, malfunction or failure resulting from use of incorrect voltages, incorrect installation, accident, misuse, neglect, build-up of dirt or dust, abuse, maladjustment of customer controls, mains supply problems, thunderstorm activity, infestation by insects or vermin, tampering or repair by unauthorised persons (including unauthorised alterations), introduction of sand, humidity or liquids, commercial use such as hotel, office, restaurant, or other business or rental use of the product, exposure to abnormally corrosive conditions or any foreign object or matter having entered the product.
4. This warranty does not cover the following items unless the fault or defect existed at the time of purchase:
 - (a) Cabinet Part(s)
 - (b) Video or Audio Tapes
 - (c) SD cards or USB devices
 - (d) User replaceable Batteries
 - (e) DVD, Blu-ray or Recordable Discs
 - (f) Video / Audio Heads from wear and tear in normal use
 - (g) Information stored on Hard Disk Drive, USB stick or SD card
 - (h) DTV reception issues caused by TV Aerial / Cabling / Wall socket(s) etc
5. Some products may be supplied with Ethernet connection hardware. The warranty is limited on such products and will not cover
 - (a) Internet and or DLNA connection / setup related problems
 - (b) Access fees and or charges incurred for internet connection
 - (c) The use of incompatible software or software not specifically stipulated in the product operations manual; and
 - (d) Any indirect or consequential costs associated with the incorrect use or misuse of the hardware, its connection to the internet or any other device.
6. To claim warranty service, when required, you should:
 - Telephone Panasonic's Customer Care Centre on 132600 or visit our website referred to below and use the Service Centre Locator for the name/address of the nearest Authorised Service Centre.
 - Send or take the product to a Panasonic Authorised Service Centre together with your proof of purchase receipt as a proof of purchase date. Please note that freight and insurance to and / or from your nearest Authorised Service Centre must be arranged by you.
 - Note that home or pick-up/delivery service is available for the following products in the major metropolitan areas of Australia or the normal operating areas of the nearest Authorised Service Centres:
 - Plasma/LCD televisions / displays (screen size greater than 103 cm)
7. The warranties hereby conferred do not extend to, and exclude, any costs associated with the installation, de-installation or re-installation of a product, including costs related to the mounting, de-mounting or remounting of any screen, (and any other ancillary activities), delivery, handling, freight, transportation or insurance of the product or any part thereof or replacement of and do not extend to, and exclude, any damage or loss occurring by reason of, during, associated with, or related to such installation, de-installation, re-installation or transit.

Panasonic Authorised Service Centres are located in major metropolitan areas and most regional centres of Australia, however, coverage will vary dependant on product. For advice on exact Authorised Service Centre locations for your product, please telephone our Customer Care Centre on 132600 or visit our website and use the Service Centre Locator.

In addition to your rights under this warranty, Panasonic products come with consumer guarantees that cannot be excluded under the Australian Consumer Law. If there is a major failure with the product, you can reject the product and elect to have a refund or to have the product replaced or if you wish you may elect to keep the goods and be compensated for the drop in value of the goods. You are also entitled to have the product repaired or replaced if the product fails to be of acceptable quality and the failure does not amount to a major failure.

If there is a major failure in regard to the product which cannot be remedied then you must notify us within a reasonable period by contacting the Panasonic Customer Care Centre. If the failure in the product is not a major failure then Panasonic may choose to repair or replace the product and will do so in a reasonable period of time from receiving notice from you.

**THIS WARRANTY CARD AND THE PURCHASE DOCKET (OR SIMILAR PROOF OF PURCHASE)
SHOULD BE RETAINED BY THE CUSTOMER AT ALL TIMES**

If you require assistance regarding warranty conditions or any other enquiries, please visit the **Panasonic Australia** website www.panasonic.com.au or contact by phone on **132 600**
If phoning in, please ensure you have your operating instructions available.

Panasonic Australia Pty. Limited

ACN 001 592 187 ABN 83 001 592 187
1 Innovation Road, Macquarie Park NSW 2113

01-01-2011

PRO-031-F11 Issue: 4.0

Disposal of Old Equipment and Batteries
Only for European Union and countries with recycling systems



These symbols on the products, packaging, and/or accompanying documents mean that used electrical and electronic products and batteries must not be mixed with general household waste.

For proper treatment, recovery and recycling of old products and used batteries, please take them to applicable collection points in accordance with your national legislation. By disposing of them correctly, you will help to save valuable resources and prevent any potential negative effects on human health and the environment.

For more information about collection and recycling, please contact your local municipality.

Penalties may be applicable for incorrect disposal of this waste, in accordance with national legislation.



Note for the battery symbol (bottom symbol):

This symbol might be used in combination with a chemical symbol. In this case it complies with the requirement set by the Directive for the chemical involved.

Manufactured by: Panasonic Corporation
Kadoma, Osaka, Japan
Importer for Europe: Panasonic Marketing Europe GmbH
Panasonic Testing Centre
Winsbergring 15, 22525 Hamburg, Germany



Panasonic Corporation
Web Site: <http://panasonic.net>



RQT9869-2B
L0214LC2044