

LG CordZero™

OWNER'S MANUAL

R9

Make sure to read the "Safety Instruction" carefully before starting to use this product. Please keep this Owner's Manual within easy reach of the user. As the product is only intended for domestic use such as household cleaning, it must not be used for commercial, experimental or industrial purposes. Make sure to fully charge the product's battery before first use of the product after purchasing it.



MFL69826103

www.lg.com

Copyright © 2018 LG Electronics Inc. All Rights Reserved



TABLE OF CONTENTS

This manual may contain images or content different from the model you purchased.

This manual is subject to revision by the manufacturer.

SAFETY INSTRUCTION.....	04
Information Safety Instruction.....	04
BEFORE USING THE ROBOT CLEANER	09
Parts	09
Accessories	11
Getting Started	12
Charging	14
OPERATION	16
Notes for Use.....	16
Control Panel.....	17
Choosing a Cleaning Mode	19
Choosing an Auxiliary Function	21
SMART FUNCTIONS	22
Using LG SmartThinQ Application	22
Using the Smart Diagnosis Function	25
MAINTENANCE.....	27
Regular Cleaning.....	27
TROUBLESHOOTING	34
Before Calling for Service.....	34
SPECIFICATIONS.....	36
System Classifications.....	36

SAFETY INSTRUCTION

EN

Information Safety Instruction

The following safety guidelines are intended to prevent unforeseen risks or damage from unsafe or incorrect operation of the appliance. The guidelines are separated into 'WARNING' and 'CAUTION' as described below.

 This symbol is displayed to indicate matters and operations that can cause risk. Read the part with this symbol carefully and follow the instructions in order to avoid risk.

WARNING

This indicates that the failure to follow the instructions can cause serious injury or death.

CAUTION

This indicates that the failure to follow the instructions can cause the minor injury or damage to the product.

IMPORTANT SAFETY INSTRUCTIONS

WARNING

To reduce the risk of explosion, fire, death, electric shock, injury or scalding to persons when using this product, follow basic precautions, including the following:

Children in the Household

This appliance is not intended for use by persons (including children) with reduced physical, sensory or mental capabilities, or lack of experience and knowledge, unless they have been given supervision or instruction concerning use of the appliance by a person responsible for their safety. Children should be supervised to ensure that they do not play with the appliance.

Technical Safety

- Place the cords from other appliances out of the area to be cleaned.
- If the supply cord is damaged, it must be replaced by authorized LG Electronics service center or dealer for assistance in order to avoid a hazard.
- Never use this vacuum cleaner with the battery or the Home Station from any other products.
- Never use the battery or the Home Station of this vacuum cleaner to another appliance.
- Do not operate the vacuum cleaner in a room where an infant or child is sleeping.
- Do not allow children to sit on the vacuum cleaner.
- Do not operate the vacuum cleaner in a room that has lit candles on furniture that the vacuum cleaner may accidentally hit or bump into.
- Do not operate the vacuum cleaner in an area where there are lit candles or fragile objects on the floor to be cleaned.
- Do not use the vacuum cleaner on a wet surface.

Installation

- Make sure the power cord of the Home Station is not crushed under a heavy object or damaged by contact with sharp objects. If the power cord is broken, do not plug it in. Take it to the authorized LG Electronics service center or dealer for assistance.
- Do not use any multi socket power boards, an extension power cable or adapter with this appliance.
- Do not install the vacuum cleaner where it may be exposed to water, rainfall or moisture.
- Do not install the vacuum cleaner and the Home Station in any high temperature environment.
- Do not place the Home Station and the vacuum cleaner near a heating device.

Battery

- Do not arbitrarily disassemble, remove or short-circuit the battery.
- Do not apply heat or shock to the battery.
- For your safety, do not remove the battery from the vacuum cleaner. If you need to replace the battery of the vacuum cleaner, take it to the authorized LG Electronics service center or dealer for assistance.

Operation

- Do not touch the power cord and plug with a wet hands.
- Pull it out by grabbing the plug, not the cord, when pulling out the power plug.
- Do not touch the prongs with your fingers, when pulling out the power plug.
- Do not force the power plug to bend.
- Do not use the power plug when it has been damaged or loosened.
- Do not allow children or pets to play with or rest upon the vacuum cleaner at any time.
- Do not use the vacuum cleaner while an object is hanging from it.
- Do not leave children or pets near the vacuum cleaner unsupervised.
- Do not operate the Robot Cleaner on narrow or elevated surfaces such as a closet, refrigerator, stairs, table, etc.
- Do not insert any part of the body, such as a hand or foot, below the brush or wheels of the vacuum cleaner while in use.
- Do not activate the vacuum cleaner on a floor that has more than a 10 degree incline.
- The vacuum cleaner is intended for indoor domestic home use.
- Do not use in commercial applications such as workshops or garages or around indoor swimming pools, etc.

Maintenance

- Turn the power supply off immediately if any abnormal sound, odor, or smoke is generated from the vacuum cleaner by removing it from the Home Station and turning off the main switch on the rear side of the unit.
- Do not spray or use inflammable materials, surfactants, or drinking water in the vicinity of the vacuum cleaner.
 - Inflammable materials: gasoline, thinner, etc.
 - Surfactant: detergent, articles for bath, etc.

CAUTION

To reduce the risk of explosion, fire, death, electric shock, injury or scalding to persons when using this product, follow basic precautions, including the following:

Installation

- Remove any cables or string from the floor before starting.
- Make sure the vacuum cleaner is not put on a table or desk, with the power ON.

Operation

- Do not use the vacuum cleaner around a banister, staircase or any other dangerous place.
- Close the top cover on the main unit before starting cleaning.
- Do not use the vacuum cleaner when the dust bin is completely full.
- Use a protective cover on the chair leg, table leg or other narrow pieces of furniture to reduce the possibility of collision or scratch.
- Do not put water, detergent, etc. into or onto the vacuum cleaner.
- Ensure that liquids do not seep into the vacuum cleaner. If liquid gets inside of the vacuum cleaner, turn off the power supply and take it to the authorized LG Electronics service center or dealer for assistance.
- Remove thin mats or carpets that may be damaged.

Maintenance

- Frequently empty the dust bin and maintain its cleanliness.
- Do not let the vacuum cleaner and charging terminals of the Home Station come into contact with metallic objects.
- Do not use or store the vacuum cleaner at temperatures below 5 °C or above 38 °C.
- Do not allow the vacuum cleaner to sweep up liquids, blades, thumb tacks, sawdust, sharp objects or ashes, hot or cold, etc.
- Do not drop the vacuum cleaner or subject it to strong impacts.
- Turn off the main power switch when the vacuum cleaner is not in use for longer periods to save energy.
- Close doors to rooms that are not required to be cleaned. The Robot cleaner may cross over low thresholds and enter into rooms that are not required to be cleaned.

BEFORE USING THE ROBOT CLEANER

Parts

Front View

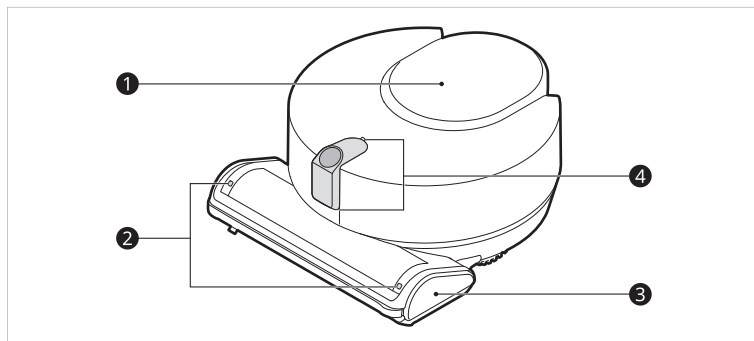

① Control Panel

③ Nozzle

② LED

④ 3D DUAL Eye

Bottom View

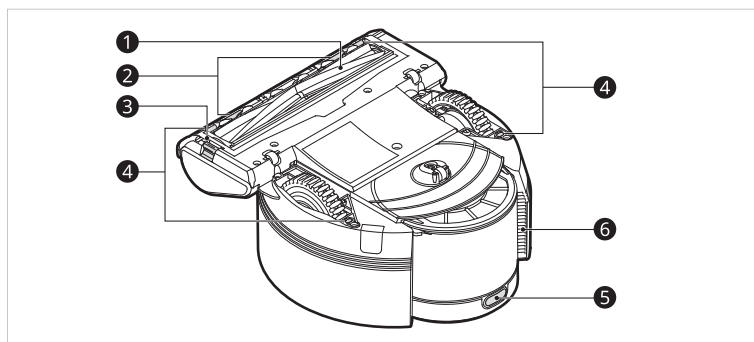

① Brush

④ Cliff Detection Sensors

② Charging Terminals

⑤ Top Cover Release Button

③ Brush Release Button

⑥ Ventilation Port

Rear View

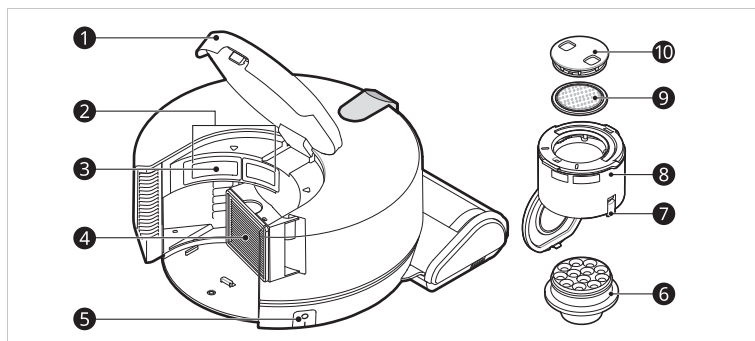

① Top Cover

② Dust Suction Port

③ Dust Sensors

④ HEPA Filter

⑤ Main Power Switch

⑥ Cyclonic Mesh Filter

⑦ Dust Bin Release Button

⑧ Dust Bin

⑨ Pre-Filter

⑩ Pre-Filter Case

Home Station

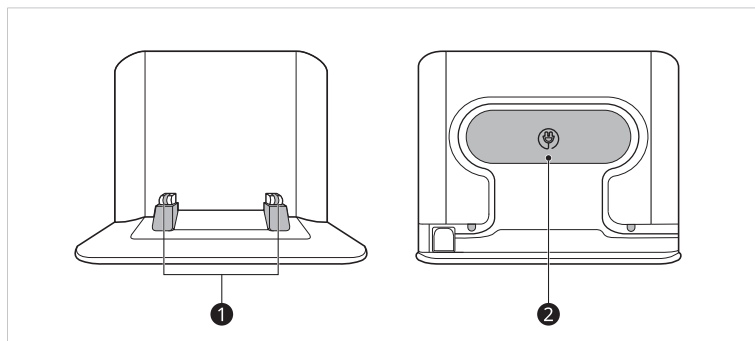

① Charging Terminals

② Cord Keeper

Accessories

Accessories will vary depending on the model purchased.

❶



❷



❸



❹

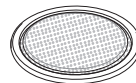

❶ Remote Control

❸ Batteries for Remote Control (AAA)

❷ Remote Control Station

❹ Pre-Filter

Getting Started

Inserting Batteries into the Remote Control

- 1 Release the tab at the back of the remote control to open the battery cover.
- 2 Insert two AAA-type batteries into the remote control.
 - Make sure the + and - ends of the batteries are aligned properly.

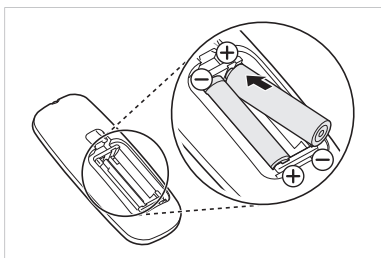

- 3 Insert the bottom of the battery cover into the remote control and close the cover.

Turning on the Power Supply

- Press the **Main Power Switch ON ①** at the back of the Robot Cleaner to turn on the power supply.
- To power off the Robot Cleaner, press the **Main Power Switch OFF ②**.

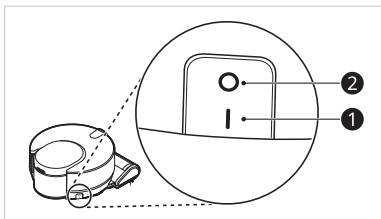

NOTE

- If the Robot Cleaner does not turn on or nothing is displayed on the Control Panel, charge the Robot Cleaner manually.
- If the main power supply is turned on during charging, turn on the standby power supply to use the Robot Cleaner.

Turning off the Standby Power Supply

Press and hold the **Start/Stop ①** button for 3 seconds or press the **Power ②** button on the remote control.

- To activate the Robot Cleaner standby, press and hold the **Start/Stop ①** button for 3 seconds or press the **Power ②** button on the remote control again.



NOTE

- If turning off the standby power supply, the Robot Cleaner will be disconnected from the SmartThinQ application.
- If 10 minutes elapse in the following situations, the Robot Cleaner automatically turns off the standby power supply.
 - When the Robot Cleaner is unable to come out of a complicated space such as the space below the dining table while cleaning.
 - When the wheels of the Robot Cleaner spin with no traction or the Robot Cleaner is caught on an obstacle and unable to come out.
 - When the Robot Cleaner is standing by in a place other than the Home Station.

Installing the Home Station

- 1 Remove the protective film attached to the Home Station, the Robot Cleaner, and the nozzle.
 - If the protective film is not removed the Robot Cleaner may have difficulty finding the Home Station or it may affect performance.
- 2 Position the Home Station against a wall on hard, level flooring to prevent sliding during docking.
 - Select a place for the Home Station (left and right sides: 1.5 m, front side: 2 m) where there are no obstacles.

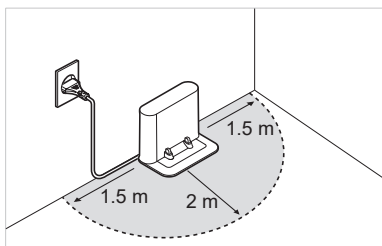

- 3 Insert the power plug into an outlet.
 - When the Home Station is turned on, the LED will light up.

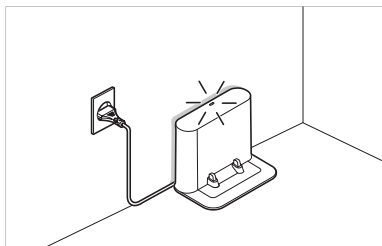

- 4 Wrap the unwanted length of power cable around the cord keeper to prevent the Robot Cleaner wheels from rolling over the cable.

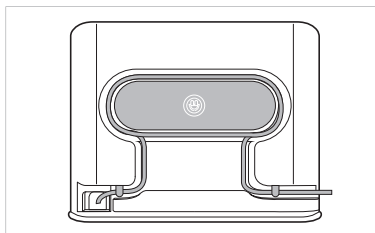

- 5 Place the Home Station against the wall so that it does not move.

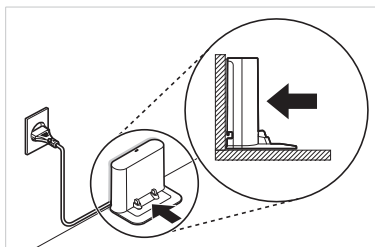

NOTE

- If power is not supplied to the Home Station, the Robot Cleaner will not charge.
- Do not place the Home Station in confined spaces, as the Robot Cleaner will not return to the Home Station easily.
- Always keep the Home Station plugged in when in use. If the Home Station is not plugged in, the Robot Cleaner will not return to the Home Station to charge automatically.
- To secure the Home Station to its location, the location of the Home Station, attach an easily removable thin double-sided adhesive tape to the rubber pad on the left and right at the bottom of the Home Station.

Charging



Notes for Use

- If the charging terminals are dirty or covered or obstructed with foreign material, the Robot Cleaner may not be charged normally. Clean using a soft cloth.
- It takes approximately 4 hours to fully charge the battery after it is completely discharged.
- The charging time depends on the status of battery.
- Charging is also available while the main power switch of the Robot Cleaner turned off.
- The remaining battery level indicator blinks while charging.
- If cleaning is not started from the Home Station or you are lifted and moved the Robot Cleaner, it may take a longer time to find the Home Station.
- Storing the Robot Cleaner for a long period of time without periodically charging the battery may cause a battery malfunction.
- If it is necessary to store the Robot Cleaner for a long period of time, then store the Robot Cleaner after fully charging the battery every 6 months.
- If charging is carried out below 5 °C, charging may not be done. Charge the Robot Cleaner indoors.

WARNING

- The battery of the Robot Cleaner will be discharged if the Robot Cleaner is stored on the Home Station while the power plug of the Home Station is not inserted into a power outlet.
- Wrap the power cable around the cord keeper to prevent the Robot Cleaner wheels from rolling over the cable. Failure to do can damage to the Robot Cleaner, or the damaged power cable cause an electric shock or injury.

Battery Level Indicator

- The battery level is indicated on the Control Panel, as follows.
 - The remaining battery level is displayed in 3 stages ( →  → ) according to the amount of power remaining.
 - The battery level indicator flashes when the Robot Cleaner needs to be charged.
 - The battery level indicator flashes while recharging is in progress, showing the battery level.
- If recharging is complete, the battery level indicator turns on. After 10 minutes, only the battery level and the Start/Stop button are displayed to save energy.

Automatic Charging

The Robot Cleaner automatically returns to the Home Station at the end of a cleaning cycle or when its battery is running low.

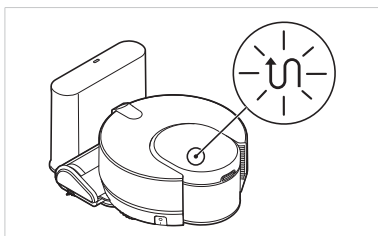

NOTE

- If the Robot Cleaner returns to the Home Station to recharge during a cleaning cycle, the cleaning mode icon flashes. After recharging, the Robot Cleaner continues the cleaning cycle.
- If the cleaning mode has been changed while charging, the Robot Cleaner will not resume cleaning.
- If the Robot Cleaner is registered in the LG SmartThinQ application, the Robot Cleaner finishes charging between 9 PM and 6 AM, the Robot Cleaner not resume cleaning.
- While charging, you can also resume cleaning by pressing the **Start/Stop** button on the Control Panel or the remote control.

Manual Charging

Moving the Robot Cleaner

If using the product for the first time after purchasing it or the battery is completely discharged, the battery should be charged manually.

- 1 Insert the power plug of the Home Station into a power outlet.
- 2 Turn on the **Main Power Switch**.
 - Charging is also available while the Main Power Switch is off.
- 3 Place the Robot Cleaner onto the charging terminals **1** by aligning it to the front side of the Home Station.
 - When charging begins, the battery charging indicator **2** turns on.

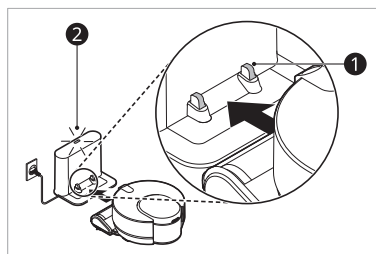

Using the Home button

To return the Robot Cleaner to the Home Station during cleaning, press the Home button on the Robot Cleaner or on the remote control. The Robot Cleaner moves to the Home Station to commence charging.

- Press the **Home** button to charge. The Robot Cleaner will move to the Home Station to charge, or the Robot Cleaner can be manually placed onto the Home Station.

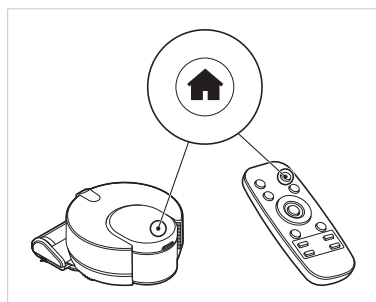

Notes for Use

Before Starting

- The cleaning time may decrease depending on conditions of use or selected auxiliary function.
- Collisions can occur during cleaning when the sensor cannot detect the obstacle (Thin chairs and table legs, gloss furniture such as a high glossy mirror or glass, etc.).
- In case of cleaning on a laminate floor, a noise may occur according to the moving direction of the Robot Cleaner.
- If the floor is not even, the brush rubs against the floor and may create a noise.
- Place the Robot Cleaner on a flat floor and start cleaning from a location where there are no obstacles, if the Robot Cleaner is manually placed to start cleaning at a location away from the Home Station.
- If the Robot Cleaner starts cleaning from the Home Station, the Robot Cleaner can find the Home Station faster when cleaning is completed.
- In case cleaning is attempted without closing the dust bin cover or assembling the dust bin, the Robot Cleaner will stop and then will announce a problem via the voice guidance.
- If water gets inside the Robot Cleaner, do not attempt to shake the water out of the Robot Cleaner. Turn off the **Main Power Switch** and place the Robot Cleaner in a well-ventilated area out of direct sunlight for at least 48 hours until completely dry.
- The Robot Cleaner can cross over thresholds that are up to 20 mm high depending on the shape and material of the threshold.
- The Robot Cleaner will navigate back to the Home Station easily, if cleaning is started from the Home Station.
- The Robot Cleaner will not return back to the Home Station, if cleaning is started while the power plug of the Home Station is not inserted into a power outlet.

Before Cleaning

- Check the following items before use:
 - Remove cables or long strings from the floor.
 - Roll up or remove thin mats or carpets with a pile longer than 20 mm.
 - Remove fragile objects and obstructions from the floor.
 - Remove foreign materials such as a long strings, metallic object, liquids, pet excreta or glass from the floor.
 - Remove any furniture with thin legs.
 - Close the doors of any room that you do not want the Robot Cleaner to enter.
 - Keep the shoes left near the porch or the bathroom at least 5 cm away from the threshold.
 - Close any balcony doors as the wheels may get stuck while cleaning.

Control Panel

Touch Buttons

You can control the Robot Cleaner by pressing the touch button icons for starting the Robot Cleaner or quickly choosing a cleaning mode.

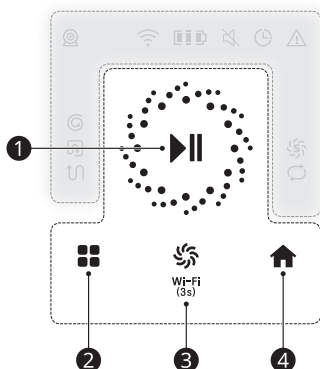

1 Start/Stop Button

- Press the **Start/Stop** button to start or stop the Robot Cleaner.
- Press and hold the **Start/Stop** button for 3 seconds to turn the Robot Cleaner on or off.

2 Mode Button

- Press the **Mode** button to set the a cleaning mode to Spiral Spot mode, Zigzag mode, and Edge mode.

3 Turbo Button / Wi-Fi Button

- Press the **Turbo** button to activate or deactivate the Turbo mode.
- Press and hold the **Turbo** button for 3 seconds to register the Robot Cleaner in the LG SmartThinQ application.

4 Home Button

- Press the **Home** button to charge the battery. The Robot Cleaner will return to the Home Station.

Status Display

The selected cleaning mode, auxiliary functions, or status of Robot Cleaner will be displayed on the Status Display.

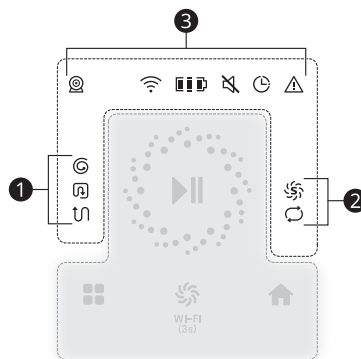

1 Displays the Cleaning Mode

- : Spiral Spot Mode
- : Edge Mode
- : Zigzag Mode

2 Displays the Auxiliary Function

- : Smart Turbo Function
- : Repeat Function

3 Displays the Status Indicator

- : Home View
- : Wi-Fi Connection
- : Battery Level
- : Mute
- : Schedule
- : Error Indicator

NOTE

- The Wi-Fi Connection indicates when the Robot Cleaner connects to the LG SmartThinQ application or a wireless network.
- The Wi-Fi Connection blinks while connecting the Robot Cleaner in the LG SmartThinQ application.
- Using the LG SmartThinQ application to schedule a cleaning time.

Remote Control

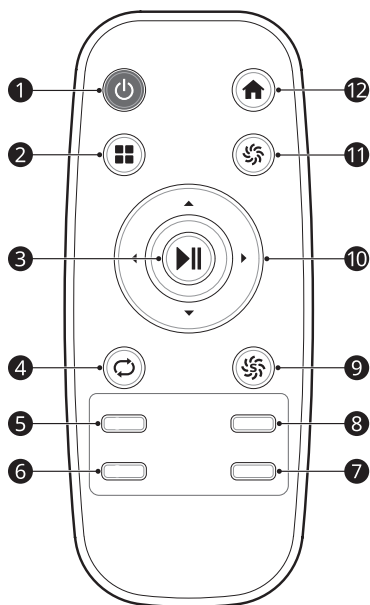

NOTE





- The Power button will only operate when the Main Power Switch is turned on.
- The Language button will only operate when the Robot Cleaner is charging on the Home Station.

- ❶ Power Button
- ❷ Mode Button
- ❸ Start/Stop Button
- ❹ Repeat Button
- ❺ Language Button
- ❻ Lock 3D DUAL Eye Button
- ❼ Smart Diagnosis Button
- ❽ Mute Button
- ❾ Smart Turbo Button
- ❿ Directional Button
- ⓫ Turbo Button
- ⓬ Home Button

Choosing a Cleaning Mode

Getting Started

Select a cleaning mode on the control panel or on the remote control.

- 1 Insert the power plug of the Home Station into a power outlet.
- 2 Press the **Mode**  button to select the desired mode as follows.
 -  : the Edge mode
 -  : the Zigzag mode
 -  : Spiral Spot mode
- 3 Press the **Start/Stop**  button to start cleaning.

NOTE

- The selected mode displays on the control panel.
- To change the cleaning mode during operation, press the **Start/Stop** button to stop the Robot Cleaner and then select another cleaning mode.
- Once selected, the new cleaning mode is retained even after the power supply is turned off. (For the Edge and the Zigzag modes only.)
- The Robot Cleaner utilizes the AI (Artificial Intelligence) technology in the Edge and the Zigzag modes.
 - The 3D DUAL Eye is included with the 3D camera sensor, 3D obstacle detection sensor. The Robot Cleaner learns where to go and identifies objects it needs to avoid.
 - The Robot Cleaner detects obstacles using the 3D DUAL Eye and remembers the locations of objects in the area being cleaned.
 - The obstacle detection sensor of the 3D DUAL Eye may not operate normally if there is a human shape or something similar within the environment.
 - When the Smart Turbo function is selected, the Robot Cleaner automatically detects dust, carpets or corners and then adjusts the suction power when cleaning.
 - If the suction power increases automatically in the Smart Turbo mode, the operating noise will become louder.

Edge Mode

The Robot Cleaner moves in zigzag movements around the whole house and cleans thoroughly including the edges up to the wall. When a wall is detected, the Robot Cleaner reduces its speed and temporarily increases the suction power.

- When a wall is detected, the Robot Cleaner reduces its speed and temporarily increases the suction power.

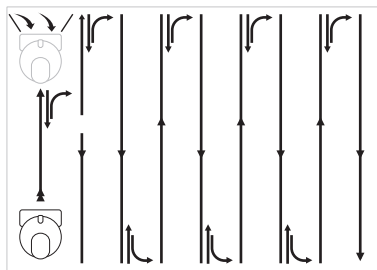

Zigzag Mode

The Robot Cleaner repeats a zigzag operation to clean the whole house without coming into contact with the wall.

- It is suitable for quick cleaning or a large cleaning area without any obstacles.
- Factory default setting is the Zigzag mode.

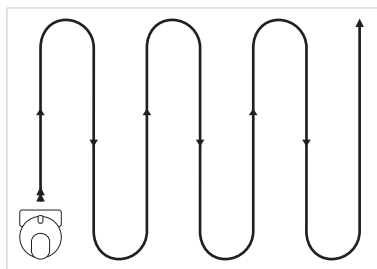

Spiral Spot Mode



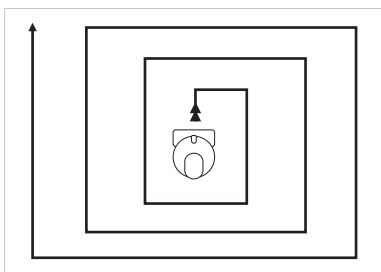

The Robot Cleaner cleans a 1.5 m × 1.5 m sized space with stronger suction power. It is convenient to use this mode for cleaning a highly contaminated area.

- After cleaning is finished, the Robot Cleaner will stop at the location where it started cleaning.
- The Spiral Spot Mode cannot be activated while the Robot Cleaner is charging.



Manual Mode

You can move the Robot Cleaner manually by pressing the directional buttons on the remote control.

- Press the **Directional** buttons on the remote control to operate the Robot Cleaner.
 - **Forward/Backward** ( ) Button: Moves the Robot Cleaner forward or backward.
 - **Left/Right Rotation** ( ) Button: Turns the Robot Cleaner counter-clockwise or clockwise.

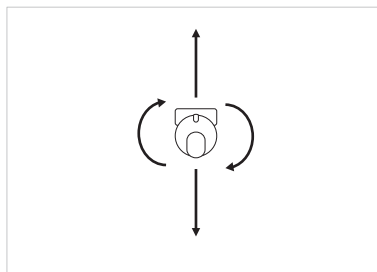

CAUTION

- Do not operate the Robot Cleaner on narrow and elevated surfaces such as a closet, refrigerator, stairs, table, etc. Be careful when pressing the directional buttons on the remote control to prevent collisions or falls.

NOTE

- When the Robot Cleaner encounters an obstacle while moving forward, it will stop automatically and move backward slightly.
- When the Robot Cleaner encounters an obstacle while rotating, it will rotate in the opposite direction.

Choosing an Auxiliary Function

These functions can allow the Robot Cleaner to clean more effectively by using the auxiliary functions.

Repeat Function

The Robot Cleaner repeats the selected cleaning mode.

To activate Repeat function, press the **Repeat** button on the remote control.

- After cleaning is finished, the Robot Cleaner changes its direction and cleans the same area again.
- To cancel the Repeat function, press the **Repeat** button again.

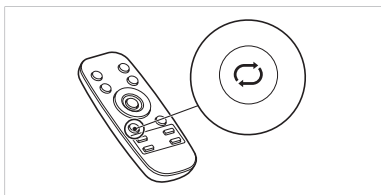

NOTE

- In the Repeat function, the Robot Cleaner cleans for at least 5 minutes, unless the cleaning is completed within 5 minutes.
- Even if the Repeat function is not selected, the Robot Cleaner repeats the cleaning if the area was cleaned within 30 minutes.

Turbo Function

The Robot Cleaner suction power is increased. Use this function for cleaning where strong suction power is necessary.

- To activate the Turbo function, press the **Turbo** button on the remote control or the Control Panel.

Note

- When the Turbo function operates, it uses more battery power.
- When the Turbo function operates, the noise of the Robot Cleaner will become louder.

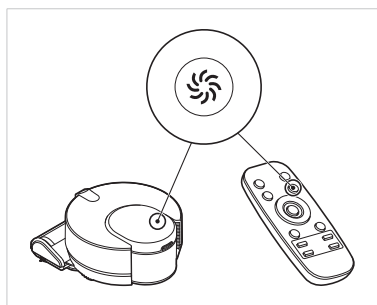

Smart Turbo Function

The Robot Cleaner automatically detects carpets, corners or dusty places and increase the suction power.

- To activate Smart Turbo function, press the **Smart turbo** button on the remote control.

NOTE

- When the Smart Turbo function operates, the noise of the Robot Cleaner will become louder.
- The Smart Turbo function is factory default setting.

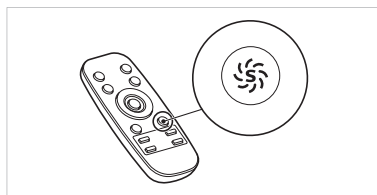

Using LG SmartThinQ Application

Things to check before using LG SmartThinQ

- 1 Check the distance between the appliance and the wireless router (WLAN network).
 - If the distance between the appliance and the wireless router is too far, the signal strength becomes weak. It may take a long time to register or installation may fail.
- 2 Turn off the **Mobile data** or **Cellular Data** on your smartphone.
 - For iPhones, turn data off by going to **Settings** → **Cellular** → **Cellular Data**.

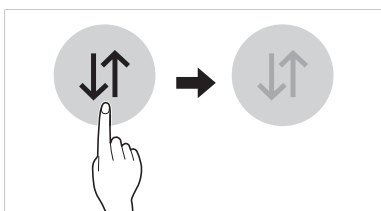

- 3 Connect your smartphone to the wireless router.

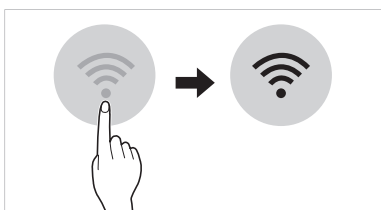

NOTE

- To verify the WLAN connection, check that **Wi-Fi**  icon on the control panel is lit.
- The appliance supports 2.4 GHz WLAN networks only. To check your network frequency, contact your Internet service provider or refer to your wireless router manual.
- LG SmartThinQ is not responsible for any network connection problems or any faults, malfunctions, or errors caused by network connection.
- If the appliance is having trouble connecting to the WLAN network, it may be too far from the router. Purchase a WLAN repeater (range extender) to improve the WLAN signal strength.
- The WLAN connection may not connect or may be interrupted because of the home network environment.
- The network connection may not work properly depending on the Internet service provider.
- The surrounding wireless environment can make the wireless network service run slowly.
- The appliance cannot be registered due to problems with the wireless signal transmission. Turn off the **Main Power Switch** and wait about a minute before trying again.
- If the firewall on your wireless router is enabled, disable the firewall or add an exception to it.
- The wireless network name (SSID) should be a combination of English letters and numbers. (Do not use special characters.)
- This manual may contain content different from the version of the the LG SmartThinQ application. This manual is subject to revision by the manufacturer.
- The LG SmartThinQ application is subject to change for appliance improvement purposes without notice to users.

Installing the LG SmartThinQ Application

Search for the LG SmartThinQ application from the Google Play Store or Apple App Store on a smartphone. Follow instructions to download and install the application.

Using the Smart Functions

The LG SmartThinQ application provides the following the Smart Functions:

Home Guard, Home View, Schedule Cleaning, Cleaning Diary, Smart Diagnosis, etc.

NOTE

- The provided functions vary depending on the model.
- Follow the guide of the LG SmartThinQ application for details to use the Smart Functions.

Home Guard

The Robot Cleaner uses motion sensor technology to automatically detect movement at the selected location, capture images and send them directly to your smartphone.

Home View

The Home View displays the real-time video of your home and remotely controls the Robot Cleaner.

Schedule Cleaning

Use Schedule Cleaning to set a regular cleaning time for the Robot Cleaner to begin cleaning.



Cleaning Diary

The Cleaning Diary records the date, cleaning mode, and start and completion times of each cleaning and views the cleaning history. Play to see an active cleaning map of that cleaning session.

Smart Diagnosis

The Robot Cleaner can self-diagnose with the Smart Diagnosis function. Refer to the 'Smart Diagnosis Function' section for details.

Using the Home Guard Function

- 1 Run the LG SmartThinQ application.
- 2 Create an account to login the application.
- 3 Register the Robot Cleaner in the application to control it.
- 4 Select a **Home Guard**  function on the menu.
- 5 Choose a starting point on the smartphone and then tap **Save**  on the smartphone.
 - The Home Guard position uses the Home station as the starting point (left and right sides: 1.5 m, front side: 3 m).

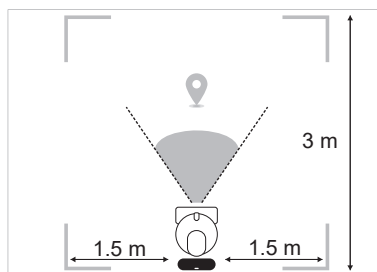

- 6 Tap **Start**  for the Home Guard function.
- 7 Select one of the auxiliary functions on the smartphone.
 - **Scheduled Guard:** You can schedule the Home Guard to begin at a set time every day.
 - **Check Photos:** You can view and save the photos that the Robot Cleaner takes. It will take 5 consecutive photos upon detecting movement. Only the last 20 photos taken are kept in the units memory at any time.
 - **Push Alert:** You can set up the Home Guard push alert setting in the **Settings** menu.

NOTE

- If the Home station is relocated, the Home Guard position needs to be set again.
- Adjust the ambient lighting to higher than 20 lux to detect movement.
- Movement may be constantly detected for households with indoor pets and sudden lighting condition changes.
- The Robot Cleaner must be charging in order to schedule or activate the Home Guard function.

RF Radiation Exposure Statement

This equipment shall be installed and used at a minimum distance of 20 cm from the human body.

Open Source Software Notice Information

To obtain the source code under GPL, LGPL, MPL, and other open source licenses, that is contained in this product, please visit <http://opensource.lge.com>.

In addition to the source code, all referred license terms, warranty disclaimers and copyright notices are available for download.

LG Electronics will also provide open source code to you on CD-ROM for a charge covering the cost of performing such distribution (such as the cost of media, shipping, and handling) upon email request to opensource@lge.com. This offer is valid for a period of three years after our last shipment of this product. This offer is valid to anyone in receipt of this information.

Using the Smart Diagnosis Function

Getting Started

The Robot Cleaner uses this Smart Diagnosis function to run a self-diagnosis. If any irregularity is found from the diagnosis, please contact the authorized LG Electronics service center.

- 1 Turn on the **Main Power Switch ①** of the Robot Cleaner and then dock the Robot Cleaner on to the Home Station.
 - The Smart Diagnosis function is only available while the Robot Cleaner is charging.

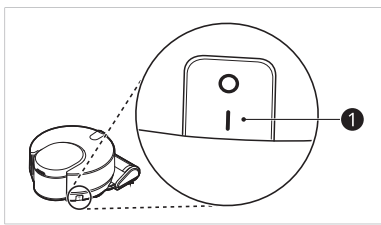

- 2 Remove items within 1 m that are in the way of the Robot Cleaner.
 - During the Smart Diagnosis, the Robot Cleaner move approximately within a 50 cm radius.
- 3 Press the **Diagnosis** button on the Remote Control and then the process starts with a voice message.
 - The Robot Cleaner returns back to the Home Station when the Smart Diagnosis has finished.

- 4 The Robot Cleaner announce the result through a voice message.
 - To repeat the voice message, press the **Home** button.

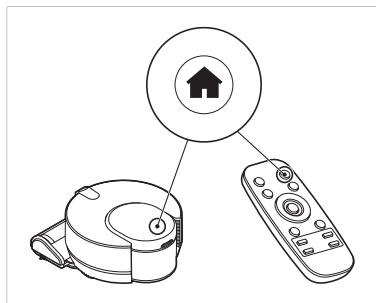

- 5 Press the **Start/Stop** button to terminate the diagnosing process.
 - After the Smart Diagnosis voice message, the Robot Cleaner will begin recharging after 1 minute.
 - If an error is detected with any of the Obstacle Detection Sensors whilst in the Smart Diagnosis, a voice message will announce, and the Robot Cleaner will not return to the Home Station.

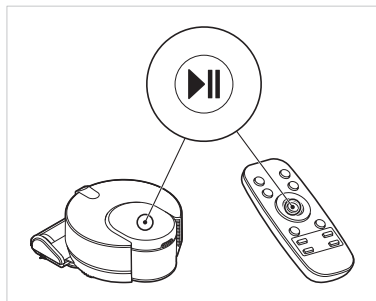

NOTE

- Be careful not to touch the Robot Cleaner or disturb its operation before Smart Diagnosis is complete. If it is accidentally interrupted, turn the Main Power Switch OFF then ON again to resume the diagnosis.
- Smart Diagnosis will not be activated in the following cases. In each case, check the problem and try again.
 - The Robot Cleaner is detached from Home Station.
 - Battery level is insufficient.
 - Dust Bin Filter is not attached.
- If there is a problem in its running, the Robot Cleaner will provide the diagnosis result from the Home Station and the Smart Diagnosis will end.
- Use the Smart Diagnosis in a place which is not too bright or too dark.
- Use the Smart Diagnosis on a flat hard floor. If the floor is carpet the diagnosis result may be incorrect.
- If there is a problem with the sensor or the motor or the problem cannot be solved through the Smart Diagnosis, contact the authorized LG Electronics service center.
- Extremely shiny surfaces may cause the sensors to react and result in an operational error.

Regular Cleaning

Notes for Use

- Turn off the **Main Power Switch** on the Robot Cleaner before cleaning the Robot Cleaner.
- If the dust bin is completely full of dust or the filter is clogged, the suction power may be reduced.
- In order to maintain the optimum suction power of the Robot Cleaner, the filter should be cleaned at least once a month.
- In order for the brush of the Robot Cleaner to operate normally, the brush should be cleaned at least once a month.
- If the brush contains foreign substances, the brush may not spin or a noise may occur during operation.

! CAUTION

- Be sure to install the filter on the dust bin. If the filter is not installed, the dust gets into the motor inside the Robot Cleaner and will cause damage to the suction motor.

Cleaning the Dust Bin

- 1 Press the **Top Cover Release (PUSH)** ❶ button to open the top cover and then pull the dust bin upward.

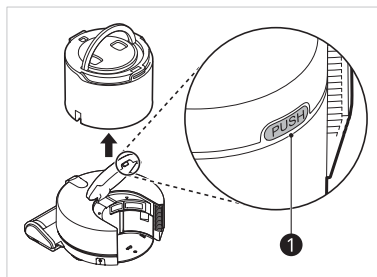

- 2 Press the **Dust Bin Release (PUSH)** ❶ button to open the dust bin cover and then empty the dust bin.

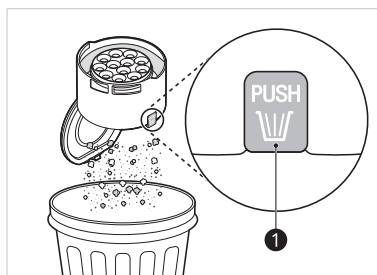

- 3 Remove any foreign substance on the rubber at the bottom of the dust bin.

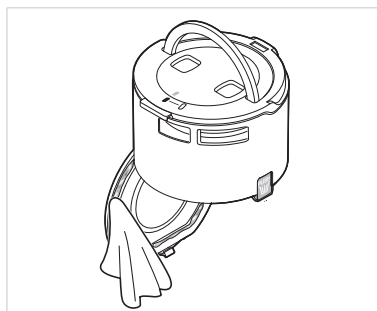

- 4** Use a dry cloth to rotate the end of Cyclonic Mesh Filter **1** to the unlocked position  and then separate it.

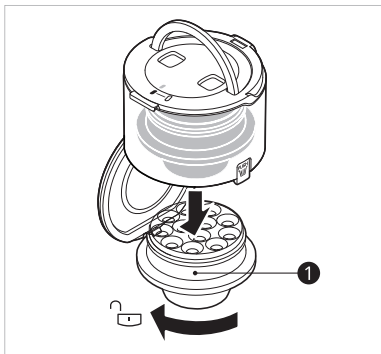

- 5** Thoroughly clean out the dust particles on the Cyclonic Mesh Filter, with a vacuum cleaner or under running water.
- To avoid odor, allow the Cyclonic Mesh Filter to dry completely in a well-ventilated area out of direct sunlight for at least 48 hours before reassembling.

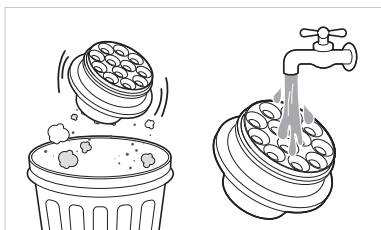

- 6** Rotate the Pre-Filter Case **1** to the unlocked position  to separate it from the dust bin.

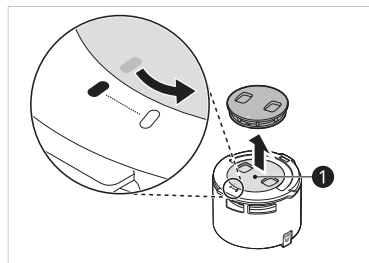

- 7** Press and lift hook **1** up to take out the Pre-Filter **2**.

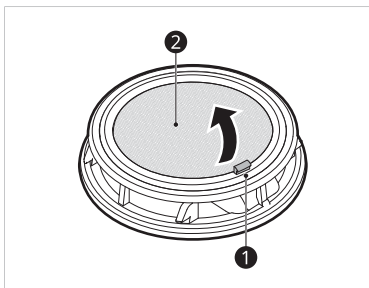

- 8** Clean the Pre-Filter using a vacuum cleaner or under running water.
- To avoid odor, allow the Pre-Filter to dry completely in a well-ventilated area out of direct sunlight for at least 48 hours before reassembling.



- 9** Wipe the dust bin with a soft cloth or wash it under running water.

- Dry it completely before using.

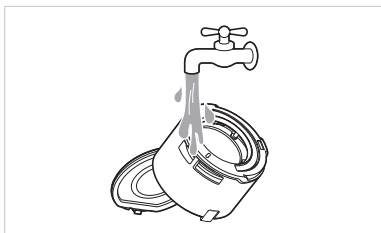

- 10** After cleaning the dust bin, assemble the Pre-Filter Case **1** by rotating it to the locked position **I** and then assemble the Cyclonic Mesh Filter **2** by rotating it to the locked position **II**.

- Be sure to close the dust bin cover.

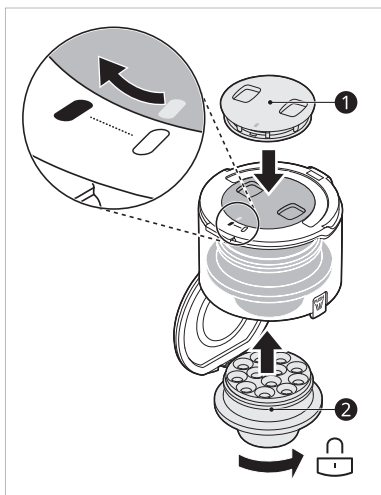

Cleaning the HEPA Filter

- 1** Separate the dust bin from the Robot Cleaner body and then pull out the HEPA Filter Case **1**.

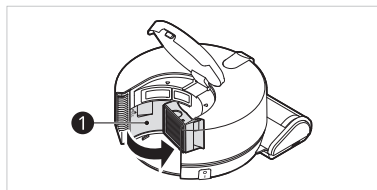

- 2** Separate the HEPA Filter **1** from the HEPA Filter Case.

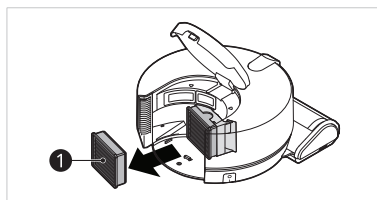

- 3** Clean the HEPA Filter using a vacuum cleaner or under running water.

- To avoid odor, allow the HEPA Filter to dry completely in a well-ventilated area out of direct sunlight for at least 48 hours before reassembling.

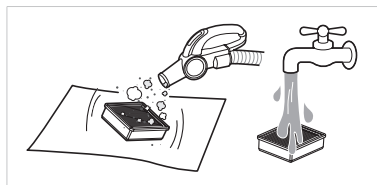

- 4** After the HEPA Filter has dried, insert the filter in the HEPA Filter Case and close the cover.

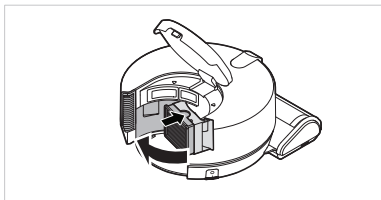

Cleaning the Brush

- 1** Place a soft cloth on the floor and place the Robot Cleaner upside down on top of the cloth.
- 2** Push the Brush Release Button **1** to separate the brush case **2** from the nozzle.

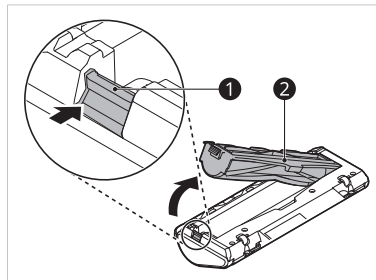

- 3** Press the brush hook **1** and pull up the brush **2** to separate from the brush case.

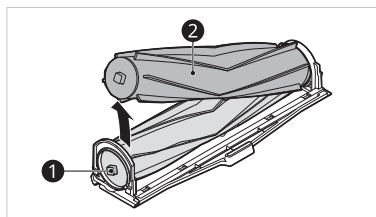

- 4** Remove foreign substances such as hair and thread from the brush and brush ends.

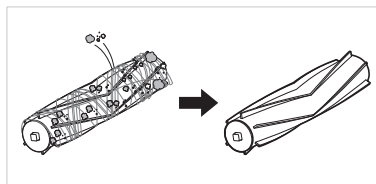

- 5** Insert the brush into the brush case, starting from its right side.

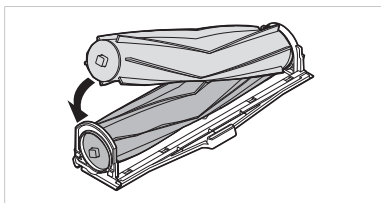

- 6** Assemble the brush case back on the nozzle.

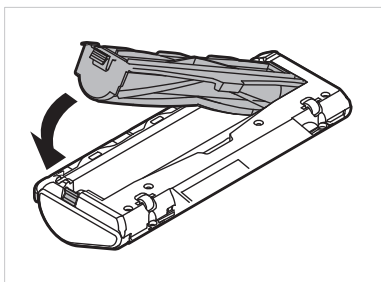

NOTE

- If the brushes have become bent, wrap it in a wet towel and wait until they have straightened out. Allow it to dry completely before reassembling.
- To avoid corroding the bearings, do not immerse the brush assembly in water while cleaning.

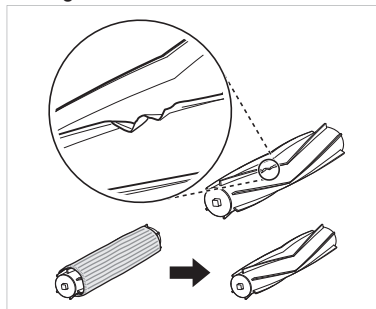

- Dust may pile up at the brush entrance on the bottom surface. Remove dust from the brush entrance periodically using a soft brush or vacuum cleaner.

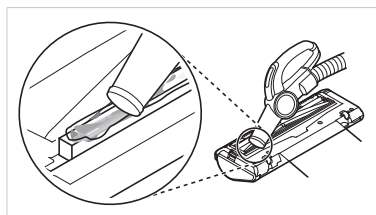

- If the suction power has become weaker, check the suction port for clogs or foreign materials. Use a stick to remove the foreign substance.

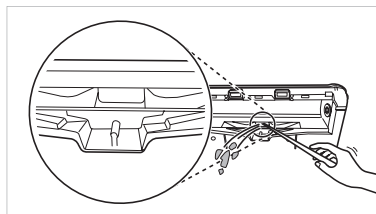

Cleaning the Sensors and the Charging Terminals

- 1 Place a soft cloth on the floor and place the Robot Cleaner on top of the cloth.
- 2 Clean the 3D DUAL Eye of the Robot Cleaner using a soft cloth.
 - Be careful not to scratch the sensors.

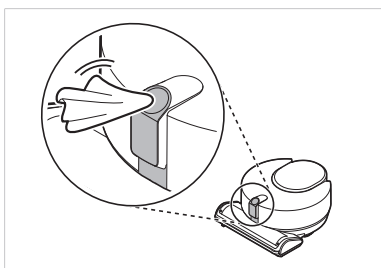

- 3 Clean the cliff detection sensors ① and the charging terminals ② of the Robot Cleaner using a cotton swab or a soft cloth.

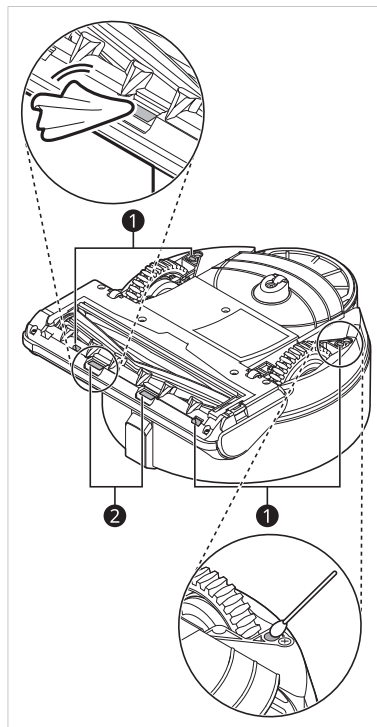

- 4 Clean the dust sensors of the Robot Cleaner using a soft cloth.

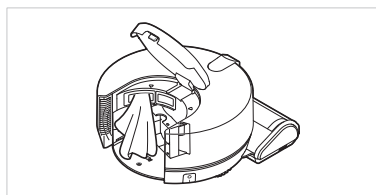

- 5 Unplug the power cord of the Home Station and then clean the charging terminals of the Home Station.

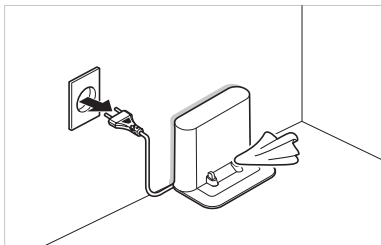

⚠ WARNING

- Pull out the power plug before cleaning the charging terminals of the Home Station. Failure to do so may cause an electric shock or injury.

⚠ CAUTION

- If the sensors or the charging terminals is damaged, discontinue use and contact an LG Electronics service center.
- Do not wipe the product with a volatile solvent or an organic solvent (thinner, solvent, acetone, etc.) Doing so will cause product damage.

NOTE

- It is very important that the cliff sensors are cleaned regularly to allow the Robot Cleaner to detect surface level differences and prevent it from falling over edges.

TROUBLESHOOTING

EN

Before Calling for Service

If following symptoms appear while using the Robot Cleaner, check it one more time. It may not be a failure.

Problem	Cause	Solution
Power cannot be turned on.	Is the Main Power Switch of the Robot Cleaner turned off?	• Turn on the Main Power Switch at the back of the Robot Cleaner.
	Is the battery discharged completely?	• Charge the battery of the Robot Cleaner manually.
Power is turned off automatically.	Did the Robot Cleaner stop for more than 10 minutes in a no charging status?	• If the Robot Cleaner has been on standby for more than 10 minutes in a no charging status, the power will be turned off automatically. Store the Robot Cleaner in a charging status.
	Did the Robot Cleaner stop for more than 10 minutes in the status of being trapped by an obstacle?	• Use the Robot Cleaner after arranging surrounding obstacles.
Charging cannot be carried out.	Is there an obstacle near the Home Station?	• Remove the obstacle near the Home Station.
	Is the power lamp on the Home Station turned off?	• Check if the power plug of the Home Station is inserted into the outlet.
	Is the charging terminals stained with foreign substances?	• Wipe the Robot Cleaner and the charging terminals of the Home Station with a soft cloth.
	Was the Robot Cleaner charged in a cool place?	• Due to the characteristics of the battery, the battery may not be charged properly at a low temperature below 5 °C. Use the Robot Cleaner after charging the battery at proper temperatures.
Suction power becomes weak.	Is there any foreign material blocking the suction port?	• Check if there is any foreign material in the suction port.
	Is the dust bin completely filled?	• Empty the dust bin.
	Is the HEPA Filter or the Pre-Filter blocked?	• Clean the HEPA Filter or the Pre-Filter.

Problem	Cause	Solution
The operational noise becomes louder.	Is the dust bin attached to the Robot Cleaner correctly?	• Attach the dust bin correctly.
	Is the HEPA Filter or the Pre-Filter attached to the dust bin correctly?	• Attach the the HEPA Filter or the Pre-Filter correctly.
	Is the brush contaminated with foreign substances?	• Remove foreign substances from the brush.
	Is the brush case installed properly?	• Install the brush case properly.
	Is the cleaning direction different from the direction of the grain on the floor?	• If cleaning is carried out in the opposite direction from the direction of the grain on the floor, a noise may occur. Clean in the direction of the grain on the floor.
The Robot Cleaner will not operate.	Is the Main Power Switch of the Robot Cleaner turned off?	• Turn on the Main Power Switch at the back of the Robot Cleaner.
	Is the battery discharged completely?	• Charge the battery of the Robot Cleaner manually.
The brush will not spin.	Is the brush installed correctly?	• Separate and install the brush again.
	Is the brush contaminated with foreign substances?	• Remove foreign substances from the brush.
The robot vacuum cleaner runs abnormally.	Is the sensor contaminated with foreign substances?	• Wipe the sensor with a soft cloth.
	Is the wheel contaminated with foreign substances?	• Remove foreign substances from the wheels.
The Robot Cleaner cannot be operated using the remote control.	Are the batteries of the remote control discharged?	• Replace the batteries of the remote control.
	Is the Robot Cleaner far away?	• Check if the Robot Cleaner is located within 3 m of the remote control signal.
	Is the Robot Cleaner turned off?	• Turn on the Robot Cleaner.
The Robot Cleaner is placed on the charging station, but the battery is not charging.	Is the LED power lamp of the Home Station on?	• Check if the power plug of the Home Station is inserted into the outlet. If the light on the power lamp is on, turn off and on the Main Power Switch.
	Are the charging terminals stained with foreign substances?	• Remove the foreign substances from the charging terminals and wipe the charging terminals with a soft cloth.

SPECIFICATIONS

EN

System Classifications

This product is a Class I laser device of which conformity assessment is conducted in accordance with the IEC 60825-1.

Robot Cleaner

Model	R9MASTER**
Maximum Physical Dimensions	286 mm (Width) × 330 mm (Depth) × 143 mm (Height)
Weight	Approximately 4.17 kg
Power Consumption	45 W (General mode) 90 W (Turbo function) 200 W (Spiral Spot mode) 310 W (Spiral Spot mode with Turbo function)
Charging Time	Approximately 4 hours
Cleaning Time (Based on general wooden floor)	Approximately 90 minutes (General mode) Approximately 60 minutes (Turbo function)

Home Station

Input	220-240 V~ 50 Hz 70 W
Output	DC 25.6 V 2.4 A

Lithium-ion Battery

Voltage / Maximum Current	DC 21.6 V / 5200 mAh
Rating	6 × 2 cells
Cell Manufacturer	LG Chem

Memo

Memo



LG CordZero™