



---

# RLT36/RLT36B

---

## 36V CORDLESS LINE TRIMMER

### OPERATOR'S MANUAL (Original Instructions)

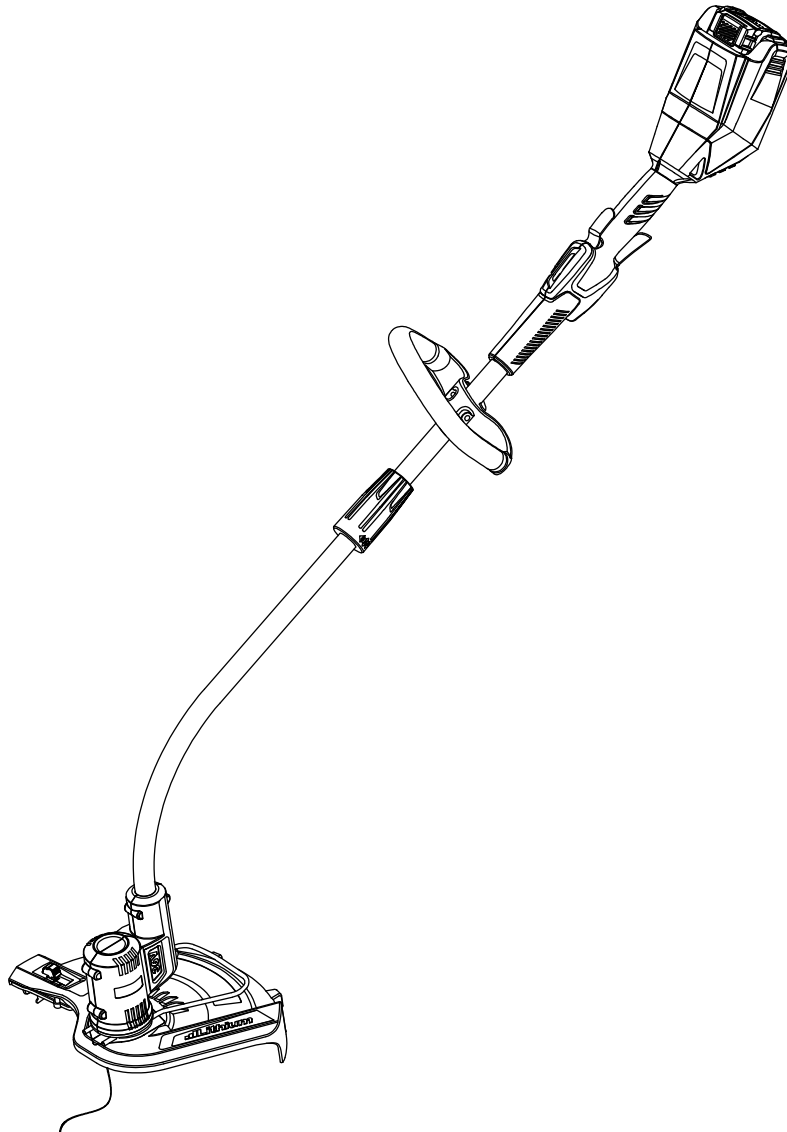

N197

#### **Important!**

It is essential that you read the instructions in this manual before assembling, maintaining and operating this machine.

# **RYOBI** RLT36 / RLT36B

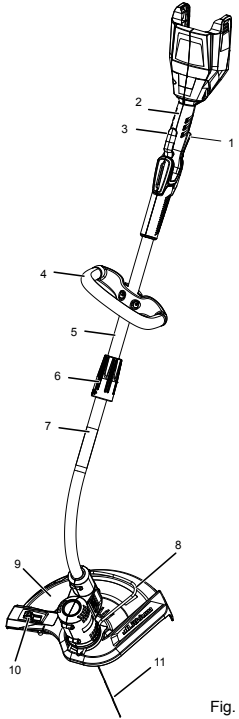

Fig. 1

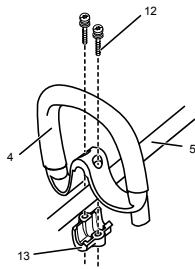

Fig. 2

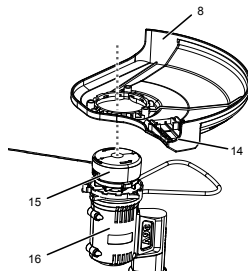

Fig. 3

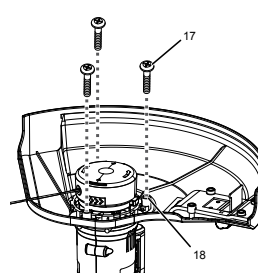

Fig. 4

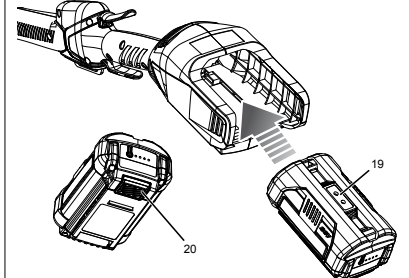

Fig. 5

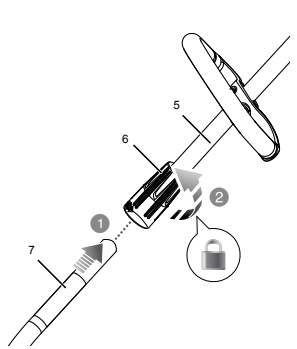

Fig. 6

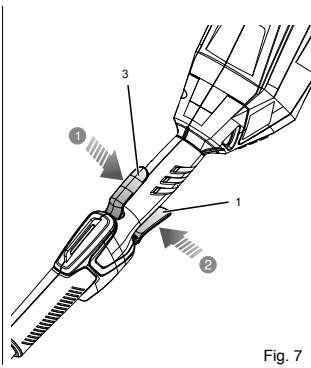

Fig. 7

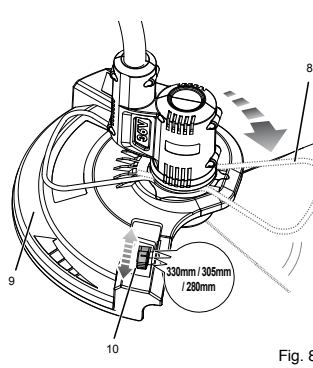

Fig. 8



Fig. 9

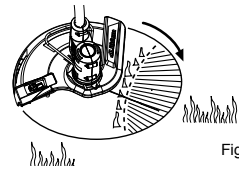

Fig. 10

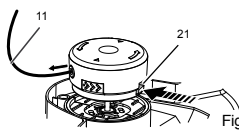

Fig. 11

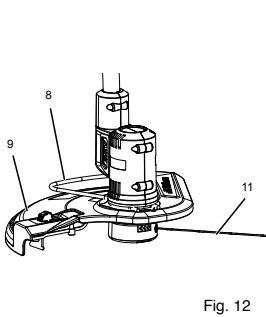

Fig. 12

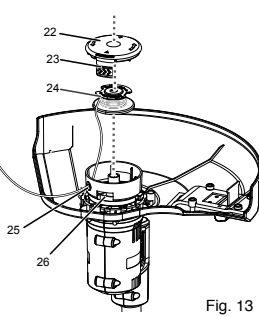

Fig. 13

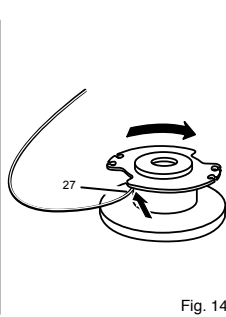

Fig. 14

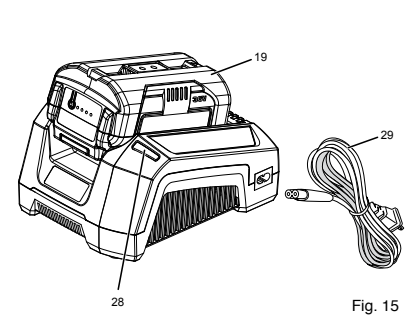

Fig. 15

## English (Original Instructions)

Your trimmer has been engineered and manufactured to a high standard for dependability, ease of operation, and operator safety. When properly cared for, it will give you years of rugged, trouble-free performance.

Thank you for buying a Ryobi product.

### SAVE THIS MANUAL FOR FUTURE REFERENCE

#### INTRODUCTION

This appliance is not intended for use by persons (including children) with reduced understanding, or lack of experience and knowledge, unless they have been given supervision or instruction concerning use of the appliance by a person responsible for their safety.

Children should be supervised to ensure that they do not play with the appliance.

This product has many features for making its use more pleasant and enjoyable.

Safety, performance, and dependability have been given top priority in the design of this product making it easy to maintain and operate.

#### INTENDED USE

This trimmer is designed for cutting grass and soft vegetation alike and for trimming grass edges in private garden areas which are not accessible with a lawn mower.

Its cutting plane should always be approximately parallel to the ground. If it is not used in this way, the possibility of injury to persons and property by thrown objects is significantly increased.

This trimmer is not recommended to be used for cutting or chopping hedges, shrubs, bushes, and flowers. It should never be used with the cutting means rotating vertically.

#### GENERAL SAFETY RULES

##### WARNING

Read all safety warnings and all instructions. Failure to follow the warnings and instructions may result in electric shock, fire and/or serious injury.

Save all warnings and instructions for future reference.

##### WARNING

When using power tools, basic safety precautions should always be taken to reduce the risk of fire, electric shock and personal injury. Also, please read and heed the advice given in these instructions.

The term "power tool" in the warnings refers to battery-operated (cordless) power tool.

- Wear protective glasses or goggles.
- Never allow children or people unfamiliar with the instructions to use the machine.
- Stop using the machine while people, especially children, or pets are nearby.
- Only use the machine in daylight or good artificial light.
- Before using the machine and after any impact, check for signs of wear or damage and repair as necessary.
- Never operate the machine with damaged guards or without the guards in place.
- Keep hands and feet away from the cutting line at all times and especially when switching on the motor.
- Take care against injury from any device fitted for trimming the line length. After extending new cutter line always return the machine to its normal operating position before switching on.
- Never fit metal cutting elements.
- Never use replacement parts or accessories not provided or recommended by the manufacturer.
- Disconnect the battery from the machine before checking, cleaning or working on the machine and when it is not in use.
- Always ensure that ventilation openings are kept clear of debris.

#### READ ALL INSTRUCTIONS

##### WORK AREA SAFETY

- Keep work area clean and well lit. Cluttered or dark areas invite accidents.
- Do not operate power tools in explosive atmospheres, such as in the presence of flammable liquids, gases or dust. Power tools create sparks which may ignite the dust or fumes.
- Keep all bystanders (especially children and pets) at least 15m away from the work area. Distractions can cause you to lose control.

##### ELECTRICAL SAFETY

- Power tool plugs must match the outlet. Never modify the plug in any way. Do not use any adapter plugs with earthed (grounded) power tools. Unmodified plugs and matching outlets will reduce risk of electric shock.
- Avoid body contact with earthed or grounded surfaces, such as pipes, radiators, ranges and refrigerators. There is an increased risk of electric shock if your body is earthed or grounded.
- Do not expose power tools to rain or wet conditions. Water entering a power tool will increase the risk of electric shock.

## English (Original Instructions)

### PERSONAL SAFETY

- Stay alert, watch what you are doing and use common sense when operating a power tool. Do not use a power tool while you are tired or under the influence of drugs, alcohol or medication. A moment of inattention while operating power tools may result in serious personal injury.
- Use personal protective equipment. Always wear eye protection. Protective equipment such as dust mask, non-skid safety shoes, hard hat, or hearing protection used for appropriate conditions will reduce personal injuries.
- Prevent unintentional starting. Ensure the switch is in the off-position before connecting to power source and/or battery pack, picking up or carrying the tool. Carrying power tools with your finger on the switch or energising power tools that have the switch on invites accidents.
- Remove any adjusting key or wrench before turning the power tool on. A wrench or a key left attached to a rotating part of the power tool may result in personal injury.
- Do not overreach. Keep proper footing and balance at all times. This enables better control of the power tool in unexpected situations.
- Dress properly. Do not wear loose clothing or jewellery. Keep your hair, clothing and gloves away from moving parts. Loose clothes, jewellery or long hair can be caught in moving parts.
- Use of hearing protection reduces the ability to hear warnings (shouts or alarms). The operator must pay extra attention to what is happening around the work area.

### POWER TOOL USE AND CARE

- Do not force the power tool. Use the correct power tool for your application. The correct power tool will do the job better and safer at the rate for which it was designed.
- Do not use the power tool if the switch does not turn it on and off. Any power tool that cannot be controlled with the switch is dangerous and must be repaired.
- Disconnect the plug from the power source and/or the battery pack from the power tool before making any adjustments, changing accessories, or storing power tools. Such preventive safety measures reduce the risk of starting the power tool accidentally.
- Store idle power tools out of the reach of children and do not allow persons unfamiliar with the power tool or these instructions to operate the power tool. Power tools are dangerous in the hands of untrained users.
- Maintain power tools. Check for misalignment or binding of moving parts, breakage of parts and any

other condition that may affect the power tool's operation. If damaged, have the power tool repaired before use. Many accidents are caused by poorly maintained power tools.

- Do not let debris build up on your trimmer. Clean often to maintain proper ventilation. Observe cleaning guides in this manual.
- Use the power tool, accessories and tool bits etc. in accordance with these instructions, taking into account the working conditions and the work to be performed. Use of the power tool for operations different from those intended could result in a hazardous situation.

### BATTERY TOOL USE AND CARE

- Recharge only with the charger specified by the manufacturer. A charger that is suitable for one type of battery pack may create a risk of fire when used with another battery pack.
- Use power tools only with specifically designated battery packs. Use of any other battery packs may create a risk of injury and fire.
- When battery pack is not in use, keep it away from other metal objects, like paper clips, coins, keys, nails, screws or other small metal objects, that can make a connection from one terminal to another. Shorting the battery terminals together may cause burns or a fire.
- Under abusive conditions, liquid may be ejected from the battery; avoid contact. If contact accidentally occurs, flush with water. If liquid contacts eyes, additionally seek medical help. Liquid ejected from the battery may cause irritation or burns.

### SERVICE

- Have your power tool serviced by a qualified repair person using only identical replacement parts. This will ensure that the safety of the power tool is maintained.

### MAINTENANCE

- After use and before storage, disconnect the machine from the battery and check for damage.
- When not in use store the machine out of the reach of children.
- Grass trimmers should only be repaired by an authorised repairer.
- Use only manufacturers recommended replacement parts and accessories.

### CAUTION







The cutter head will continue to rotate for a few seconds after switching off.

- The vibration level during actual use of the power tool can differ from the declared total value depending on the ways in which the tool is used.

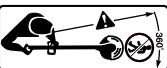

## English (Original Instructions)

### SYMBOLS

Some of the following symbols may be used on this tool. Please study them and learn their meaning. Proper interpretation of these symbols will allow you to operate the tool effectively and safely.

SYMBOL	DESIGNATION/EXPLANATION
	Precautions that involve your safety.
	Read the operation manual and follow all warnings and safety instructions.
	Wear eye and hearing protection.
	Thrown objects can ricochet and result in personal injury or property damage. Wear protective clothing and boots.
	Keep all bystanders, especially children and pets, at least 15m from the operating area.
	Beware of thrown or flying objects to bystanders. Keep bystanders a safe distance away from the machine.
	Do not expose to rain or in damp conditions.

The following signal words and meanings are intended to explain the levels of risk associated with this product.

SYMBOL	SIGNAL	MEANING
	<b>DANGER:</b>	Indicates an imminently hazardous situation, which, if not avoided, will result in death or serious injury.
	<b>WARNING:</b>	Indicates a potentially hazardous situation, which, if not avoided, could result in death or serious injury.
	<b>CAUTION:</b>	Indicates a potentially hazardous situation, which, if not avoided, may result in minor or moderate injury.
	<b>CAUTION:</b>	(Without Safety Alert Symbol) Indicates a situation that may result in property damage.

### SERVICE

Servicing requires extreme care and knowledge and should be performed only by a qualified service technician. For service we suggest you return the product to your nearest authorised service centre for repair. When servicing, use only genuine replacement parts.

### WARNING

The operation of any power tool can result in foreign objects being thrown into your eyes, which can result in severe eye damage. Before beginning power tool operation, always wear safety goggles, safety glasses with side shields, or a full face shield when needed.

## English (Original Instructions)

### SPECIFICATIONS

Model	RLT36	RLT36B
Voltage	36 Volts	
No Load Speed	9,000 - 10,000 rpm	
Cutting head	Automatic feed	
Cutting Line Diameter	1.5 mm	
Cutting Path Diameter	280 - 330 mm	
Measured sound pressure level	LPA: 75.8 dB(A), KPA: 2 dB(A)	
Measured sound power level	LwA: 94.6 dB(A), KwA: 2 dB(A)	
Vibration	ah = 1.70 m/s <sup>2</sup> , K = 1.5 m/s <sup>2</sup>	
Battery pack	1 x BPL3626	
Charger	1 x BCL3620	
Weight	4.1 kg (with battery)	2.73 kg (without battery)

### ASSEMBLY

#### UNPACKING

This product requires assembly.

- Carefully remove the product and any accessories from the box. Make sure that all items listed in the packing list are included.

#### WARNING

Do not use this product if any parts on the Packing List are already assembled to your product when you unpack it. Parts on this list are not assembled to the product by the manufacturer and require customer installation. Use of a product that may have been improperly assembled could result in serious personal injury.

- Inspect the product carefully to make sure no breakage or damage occurred during shipping.
- Do not discard the packing material until you have carefully inspected and satisfactorily operated the product.

### PACKING LIST

Line trimmer  
Front handle

Grass deflector  
Plant protector  
Battery (RLT36 only)  
Charger (RLT36 only)  
Operator's manual

#### WARNING

If any parts are damaged or missing do not operate this product until the parts are replaced. Use of this product with damaged or missing parts could result in serious personal injury.

#### WARNING

Do not attempt to modify this product or create accessories not recommended for use with this product. Any such alteration or modification is misuse and could result in a hazardous condition leading to possible serious personal injury.

#### WARNING

To prevent accidental starting that could cause serious personal injury, always remove the battery pack from the product when assembling parts.

### DESCRIPTION

1. Variable speed trigger
2. Rear handle
3. Lock-out trigger
4. Front handle
5. Upper shaft
6. Shaft coupling
7. Curved shaft
8. Plant protector
9. Grass deflector
10. Cutting diameter slide
11. Cutting line
12. Bolts
13. Bracket
14. Line cut-off blade
15. Cutting head
16. Motor housing
17. Screws
18. Screw holes
19. Battery pack
20. Battery latch button
21. Line release button
22. Spool cover
23. Spool cover lock buttons
24. Spool

## English (Original Instructions)

- 25. Eyelet
- 26. Slots
- 27. Anchor hole
- 28. Charger
- 29. Charger cable

### ATTACHING THE FRONT HANDLE

See Figure 2.

- Remove the bolts and bracket from the front handle.
- Install the front handle onto the upper shaft.
- Place the bolt through the front handle and securely tighten them into the captive nuts on the bracket.

### ATTACHING GRASS DEFLECTOR

See Figure 3 - 4.

#### WARNING

The line cut-off blade on the grass deflector is sharp. Avoid contact with the blade. Failure to avoid contact can result in serious personal injury.

- Remove supplied screws from the motor housing.
- Fit the plant protector into the slots around the base of the motor housing.
- Fit the grass deflector into the slots on trimmer head.
- Turn counterclockwise to lock grass deflector into place.
- Line up the screw holes in the grass deflector with the holes in the motor housing head.
- Install supplied screws and tighten by turning clockwise with a phillips screwdriver.

### OPERATION

#### WARNING

Do not allow familiarity with products to make you careless. Remember that a careless fraction of a second is sufficient to inflict serious injury.

#### WARNING

Always wear eye protection. Failure to do so could result in objects being thrown into your eyes resulting in possible serious injury.

#### WARNING

Never use blades, flailing devices, wire, or rope on this product. Do not use any attachments or accessories not recommended by the manufacturer of this product. The use of attachments or accessories not recommended can result in serious personal injury.

For complete charging instructions, refer to the Operator's Manuals for your Ryobi battery pack and charger models.

**NOTE:** To avoid serious personal injury, always remove the battery pack and keep hands clear of the lock-out button when carrying or transporting the tool.

### TO INSTALL BATTERY PACK

See Figure 5.

- Place the battery pack in the trimmer. Align raised ribs on battery pack with grooves in the trimmer's battery port.
- Make sure the latch on bottom of the battery pack snaps in place and that battery pack is fully seated and secure in the trimmer before beginning operation.

### TO REMOVE BATTERY PACK

See Figure 5.

- Release the variable speed control trigger to stop the trimmer.
- Press and hold the battery latch button at the bottom of the battery pack.
- Remove battery pack from the trimmer.

### SHAFT ASSEMBLY

See Figure 6.

The shaft's length cannot be adjusted.

- Insert the curved shaft into the shaft coupling on the upper shaft.
- Tighten the coupling by turning clockwise. Make sure the upper and lower part of shafts are securely tightened before reinstalling the battery pack.

### STARTING/STOPPING THE TRIMMER

See Figure 7.

- To start the trimmer, grip the front handle with one hand while holding the rear handle with your other hand making sure to depress the lock-out trigger while squeezing the variable speed trigger.
- To stop the trimmer, just release the variable speed control trigger.

### OPERATING THE TRIMMER

See Figure 9.

Follow these tips when using the trimmer:

## English (Original Instructions)

- Hold the trimmer with your right hand on the rear handle and your left hand on the front handle.
- Keep a firm grip with both hands while in operation.
- Trimmer should be held at a comfortable position with the rear handle about hip height.
- Cut tall grass from the top down. This will prevent grass from wrapping around the shaft housing and cutting head which may cause damage from overheating.

If grass becomes wrapped around the cutting head:

- Remove the battery pack from the trimmer.
- Remove the grass.

### WARNING

Contact with the trimmer cutting head while operating can result in serious personal injury.

### CUTTING TIPS

See Figure 10

- Keep the trimmer tilted toward the area being cut; this is the best cutting area.
- The trimmer will cut better when moved from left to right across the area to be cut; it is less effective when moved from right to left.
- Use the tip of the cutting line to do the cutting; do not force cutting head into uncut grass.
- Wire and picket fences cause extra cutting line wear, even breakage. Stone and brick walls, curbs, and wood will wear cutting line rapidly.
- Avoid trees and shrubs. Tree bark, wood moldings, siding, and fence posts can easily be damaged by the cutting line.

### ADVANCING CUTTING LINE

**NOTE:** The trimmer is equipped with an auto-feed head. Bumping the head to try to advance the line will damage the trimmer and void the warranty.

- With the trimmer running, release the switch trigger.
- Wait two seconds, and press the switch trigger.

**NOTE:** The cutting line will extend approximately 6.5mm with each stop and start of the trigger until the cutting line reaches the length of the grass deflector cut-off blade.

- Resume trimming.

### ADVANCING THE CUTTING LINE MANUALLY

See Figure 11.

- Remove the battery pack.
- Push the black button located on the cutting head while pulling on cutting line to manually advance the cutting line.

- After extending new cutter line, always return the machine to its normal operating position before switching on.

### ADJUSTABLE CUTTING DIAMETER

See Figure 8

- Remove the battery pack.
- Rotate the plant protector to its working position to avoid cutting flowers or plants by mistake.
- Adjust the "cutting diameter slide" on the grass deflector to adjust the cutting path diameter. There are 3 diameter options: 330mm, 305mm and 280mm.

**Note:** a smaller diameter cutting path will maximize run time and cutting speed, while a larger cutting path will help complete the trimming task quicker.

### LINE CUT-OFF BLADE

See Figure 12.

This trimmer is equipped with a line cut-off blade on the grass deflector. For best cutting, advance line until it is trimmed to length by the line cut-off blade. Advance line whenever you hear the engine running faster than normal, or when trimming efficiency diminishes. This will maintain best performance and keep line long enough to advance properly.

### WARNING

When servicing, use only genuine replacement parts. Use of any other parts may create a hazard or cause product damage.

### WARNING

To avoid serious personal injury, always remove the battery pack from the tool when cleaning or performing any maintenance.

### GENERAL MAINTENANCE

Before each use, inspect the entire product for damaged, missing, or loose parts such as screws, nuts, bolts, caps, etc. Tighten securely all fasteners and caps and do not operate this product until all missing or damaged parts are replaced. Please call Ryobi Customer Service for assistance.

Avoid using solvents when cleaning plastic parts. Most plastics are susceptible to damage from various types of commercial solvents and may be damaged by their use. Use clean cloths to remove dirt, dust, oil, grease, etc.



## English (Original Instructions)

### **WARNING**

Do not at any time let brake fluids, gasoline, petroleum-based products, penetrating oils, etc., come in contact with plastic parts. Chemicals can damage, weaken or destroy plastic which may result in serious personal injury.

Only the parts shown on the parts list are intended to be repaired or replaced by the customer. All other parts should be replaced at an Authorised Service Centre.

### **CHARGER AND BATTERY PACK**

BPL3626 - 36V DC 2.6Ah Lithium battery pack

BCL3620 - 36V charger

### **ACCESSORY**

RAC126 - Complete spool for RLT36 (1pcs)

### **BATTERY PACK REMOVAL AND PREPARATION FOR RECYCLING**

Contact customer service for the latest replacement parts and accessories.

### **WARNING**

Upon removal, cover the battery pack's terminals with heavy-duty adhesive tape. Do not attempt to destroy or disassemble battery pack or remove any of its components. Lithium-ion and nickel-cadmium batteries must be recycled or disposed of properly. Also, never touch both terminals with metal objects and/or body parts as short circuit may result. Keep away from children. Failure to comply with these warnings could result in fire and/or serious injury.

### **SPOOL REPLACEMENT**

See Figure 13.

Use only twist 1.5mm diameter monofilament cutting line. Use original manufacturer's replacement cutting line for best performance.

- Remove the battery pack.
- Push in tabs on side of spool cover.
- Pull spool cover up to remove.
- Remove the old spool.
- To install the new spool, make sure the cutting line is captured in the slot on the new spool. Make sure the end of the cutting line is extended approximately 15cm beyond the slot.
- Install the new spool so that the cutting line and slot align with the eyelet in the cutting head. Thread the cutting line into the eyelet.

- Pull the cutting line extending from the cutting head so the cutting line releases from the slot in the spool.
- Reinstall the spool cover by depressing tabs into slots and pushing down until spool cover clicks into place.

### **CUTTING LINE REPLACEMENT**

See Figures 13 - 14.

- Remove the battery pack.
- Remove the spool from the cutting head.

**NOTE:** Remove any old cutting line remaining on the spool.

- Cut a piece of cutting line approximately 3m long. Use only 1.5mm diameter monofilament cutting line.
- Insert the cutting line into the anchor hole in the upper part of the spool. Wind the cutting line around the upper part of the spool clockwise, as shown by the arrows on the spool. Place cutting line in the slot on upper spool flange, leaving about 15cm. extended beyond the slot. Do not overfill. After winding the cutting line, there should be at least 6.5mm between the wound cutting line and the outside edge of the spool.
- Replace the spool, and the spool cover. Refer to spool replacement earlier in this manual.

### **STORING THE TRIMMER**

- Remove the battery pack from the trimmer before storing.
- Clean all foreign material from the trimmer.
- Store it in a place that is inaccessible to children.
- Keep away from corrosive agents such as garden chemicals and salts.
- Store and charge your batteries in a cool area. Temperatures above or below normal room temperature will shorten battery pack life.
- Never store batteries in a discharged condition. Wait for battery pack to cool and fully charge immediately.
- Store the battery pack where the temperature is below 27°C and away from moisture.
- All batteries gradually lose their charge. The higher the temperature, the quicker they lose their charge. If you store your unit for long periods of time without using it, recharge the batteries every month or two. This practice will prolong battery pack life.

## English (Original Instructions)

### TROUBLESHOOTING

Problem	Possible cause	Solution
String will not advance when using the auto-feed head.	String is welded to itself.	Lubricate with silicone spray.
	Not enough string on spool.	Install more string. Refer to string replacement earlier in this manual.
	String is worn too short.	Pull string while pressing line release button.
	String is tangled on spool.	Remove string from spool and rewind. Refer to string replacement earlier in this manual.
Grass wraps around shaft housing and cutting head.	Cutting tall grass at ground level.	Cut tall grass from the top down to prevent wrapping.
Motor fails to start when switch trigger is depressed.	Battery is not secure.	To secure the battery pack, make sure the latch on bottom of the battery pack snaps into place.
	Battery is not charged.	Charge the battery pack according to the instructions included with your model.
	Shaft not connected completely.	Make sure the lower curve shaft is fully seated and secured in the shaft coupling on the upper shaft.

# TECHTRONIC INDUSTRIES AUSTRALIA PTY LIMITED

## **GUARANTEE**



Subject to the guarantee condition below, this Ryobi tool (hereinafter called "the product") is guaranteed by TECHTRONIC INDUSTRIES AUSTRALIA PTY LIMITED (hereinafter called "the Company") to be free from defects in material or workmanship for a period of 24 months from the date of original purchase covering both parts and labour. Under the terms of this guarantee, the repair or replacement of any part shall be the opinion of the Company or its authorised service centre. Should service become necessary during the warranty period, the owner should contact the customer service HELPLINE 1300 361 505 or contact the retailer from whom the product was purchased.

In order to obtain guarantee service, the owner must present the sales docket and Guarantee Certificate to confirm date of purchase. This product is sold by the dealer or service centre as principal and the dealer has no authority from the Company's behalf except as herein contained or herein referred to.

### Guarantee Conditions

This guarantee only applies provided that the product has been used in accordance with the manufacturer's recommendations under normal use and reasonable care (in the opinion of the Company) and such

guarantee does not cover damage, malfunction or failure resulting from misuse, neglect, abuse, or used for a purpose for which it was not designed or is not suited and no repairs, alterations or modifications have been attempted by other than an authorised service centre. This guarantee will not apply if the tool is damaged by accident or if repairs arise from normal wear and tear. The Company accepts no additional liability pursuant to this guarantee for the costs of travelling or transportation of the product or parts to and from the service dealer or service centre - such costs are not included in this guarantee.

Certain legislation, including the Trade Practices Act, 1974 (as amended) and other state and territorial laws give rights to the buyer and impose liability on the seller in certain circumstances. Nothing herein shall have the effect of excluding, restricting or modifying any condition, guarantee, right or liability imposed, to the extent only that such exclusion, restriction or modification would render any term herein void.



### **TECHTRONIC INDUSTRIES (AUSTRALIA) PTY. LTD.**

Level 1, 660 Doncaster Road,  
Doncaster, Victoria 3108,  
Australia

Tel: 1300 361 505 Fax: 1800 807 993  
[www.ryobi.com.au](http://www.ryobi.com.au)

### **TECHTRONIC INDUSTRIES N.Z. LIMITED**

Auckland: 27 Clemow Drive, Mt Wellington, N.Z.

Tel: (09) 573 0230 Free Call: 0800 279 624 Fax: (09) 573 0231  
Contact during normal business hours.  
[www.ryobi.co.nz](http://www.ryobi.co.nz)

### **This Guarantee Form Should Be Retained By The Customer At All Times**

For your record and to assist in establishing date of purchase (necessary for in-guarantee service) please keep your purchase docket and this form completed with the following particulars.

Purchased From \_\_\_\_\_

Address Of Dealer \_\_\_\_\_

Date \_\_\_\_\_ Model No \_\_\_\_\_ Serial No \_\_\_\_\_

Present This Form With Your Purchase Docket When Guarantee Service Is Required.